

**TRIKKE**<sup>TM</sup>  
ELECTRIC VEHICLES

*Pon-e*

Twist Grip Throttle

Brake Levers with  
Parking Lock  
Feature

Adjustable Handlebar Height  
with Quick Release

Quick-Swap  
Lithium Battery

Front Hub Motor  
(FWD model)  
350W

Dual Hub Motors  
(2WD Model)  
600W

High Pressure  
Air Tires  
on Alloy Rims

Patented  
High Performance  
3CV Cambering System

T8air Deluxe Carving  
Vehicle with Foldable  
Aluminum Frame



trikke.com



**TRIKKE**<sup>TM</sup>

ELECTRIC VEHICLES

*Pon-e*

Trikke EV - Pon-e Owner's Manual V7 06/30/18

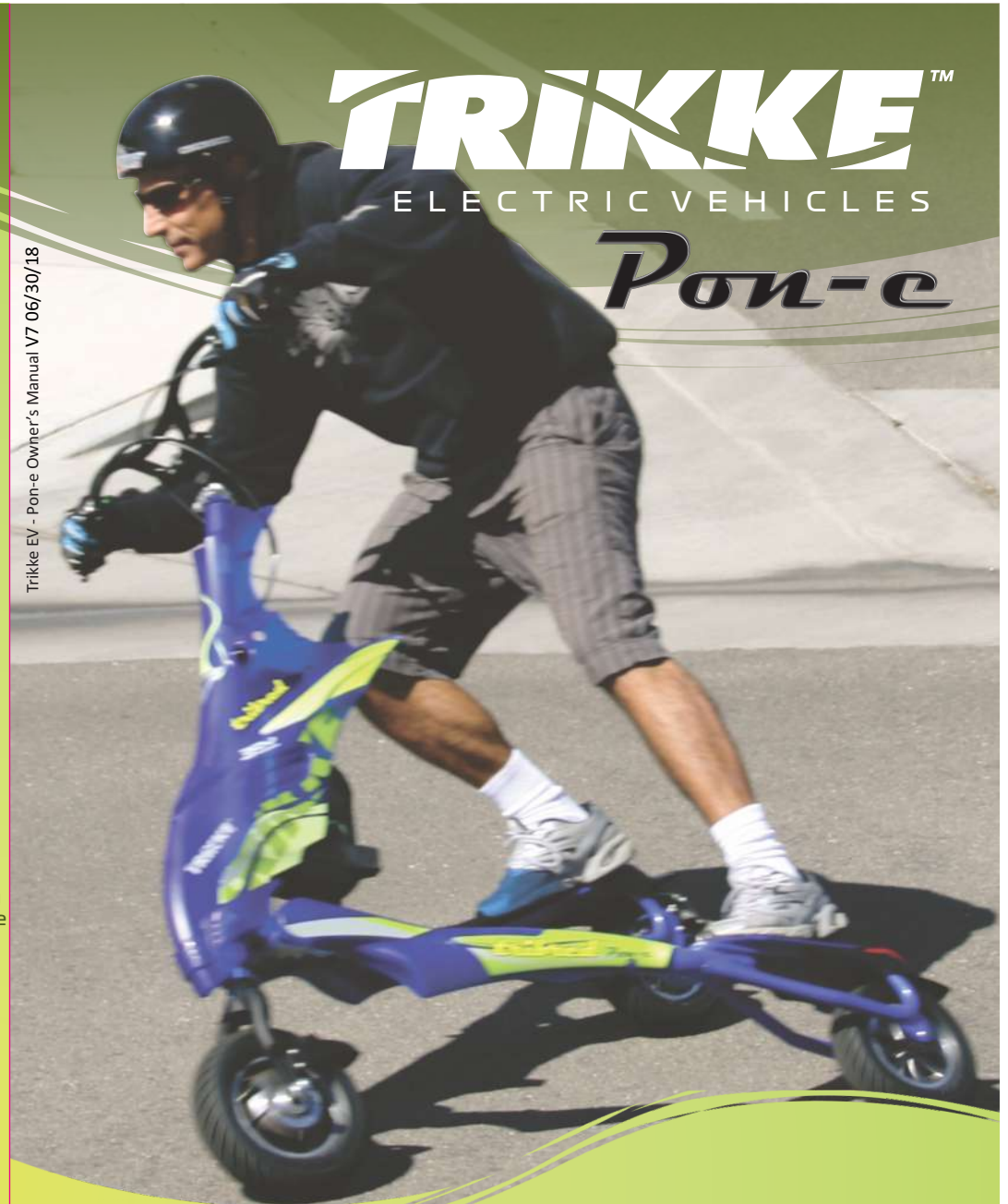

**Owner's Manual**

THIS MANUAL REFERS TO THE FOLLOWING MODELS:

Pon-e FWD 48V  
Pon-e 2WD 48V



**IT IS IMPORTANT TO READ THE  
WARNINGS, SAFETY INFORMATION  
AND RIDING TIPS**

Thank you for purchasing a Trikke<sup>™</sup> product. This manual is designed to help you get the most out of your Trikke Electric Vehicle. The warnings and instructions have been carefully prepared to make your experience safer and more enjoyable. Use common sense when riding. Read and understand the Safety Information section on page 18.



READ AND UNDERSTAND the sections of assembly, maintenance and safety in the owner's manual before riding. Always follow the directions and read all warnings.

- Always use proper safety equipment when riding the Trikke EV including a helmet approved by ANSI, Snell, CPSC, ASTM or DIN EN1078. Use proper footwear and make sure that shoes with laces are properly tied before riding.
- Avoid water, bumps, gravel, sand, cracks, uneven surfaces or obstacles that may suddenly block your way or cause you to lose control. The Trikke EV is not intended for off road use. Avoid using at night.
- Riding with only one hand or no hands can be extremely dangerous. Use both hands to hold the handlebars firmly at all times. Do not push too hard or apply uneven pressure to the two different sides of the handlebars. Do not make sudden sharp turns or apply your body weight on the handlebars when turning. Such actions can make the front wheel of the vehicle quickly turn to one side and causing the vehicle to "jack-knife" or stop suddenly, which can cause fall and serious injury to the rider.
- Tricks, riding or rolling backwards and/or extreme riding are not recommended on the Trikke EV. Riding this way you can damage the product, voiding your warranty and may result in injury or death.
- Do not pull up on the handlebars because in doing so the rider can slip off the foot platforms, resulting in serious injury or death. The rider must keep his weight within the area delineated by the three wheels and step on the center or frontal part of the deck, never on the back.
- 
- Riding down hills is not recommended, especially for novice riders. The Trikke EV is designed primarily for use on flat, dry asphalt. Extreme caution should be used when riding on any inclined surface.
- We recommend that you do not exceed the Trikke EV maximum rider's weigh limit of 250 lbs (113kg).
- A rider should be constantly on the lookout for obstacles, debris, cracks or holes in the riding path, allowing them to be anticipated and avoided.



- Because of the speed increase, the risk of injury and death are increased when riding with the electric motor. Attention to the ride is a constant.
- The braking to a full stop, at high speed, in a safe environment, to assess the distance required to stop.
- Be aware of low objects. You are taller than you think when you ride the Trikke EV. Be ready to duck for tree branches, street signs, etc..
- Whenever you ride, follow the traffic rules, including traffic signs, traffic lights and crosswalks. Usually, you must follow the same rules as a bicycle or an electric bicycle.
- Tire wear, puncture, or blowout may result in sudden loss of control, which can cause serious injury. Always make sure that the tire maintenance is being done correctly.
- Braking and locking or skidding with the rear wheels will damage the tires, and such damage is not covered under warranty. Rider may lose control and fall when locking the wheels during braking. Control braking power by the force applied on the brake lever.
- If you do not have the proper tools or find that you are unable to understand the assembly instructions, contact an authorized dealer to assemble the Trikke EV for you.
- Stop riding immediately if you suspect that some part of the vehicle is not working properly. Inspect the vehicle to confirm what the problem is. Contact your dealer or TRIKKE Technical Support directly if you suspect that there is a malfunction or defect that affects safe operation.
- If you do not understand how to operate the Trikke EV properly, do not use it. Contact your dealer or Technical Support Trikke for proper training.
- Always inspect your vehicle before each use and make sure the handlebar clamp and folding mechanism of the arms are locked in place. Read the important assembly, operation and maintenance information in this manual.
- Test the brakes properly before each use; always engage both brakes equally with your weight evenly distributed over the rear wheels.



- Children must be supervised by an adult while riding. The parent is responsible for proper maintenance and vehicle inspection before each use. The Trikke EV is not recommended for children under 13 years of age or less than 5 feet tall.
- Always use caution when you are riding close to other vehicles, pedestrians, and especially near cars if you're riding on a street. Obey all traffic laws. Be courteous to drivers of other vehicles and pedestrians. Share the road!
- Do not modify your Trikke EV. Use only original Trikke parts or accessories. See limited warranty for restrictions on use of non-original parts or modifications.
- Any modification of the electrical system will void the warranty, to increase the speed or power of the motor.
- The electrical system is designed to operate at 48 volts. Using any other batteries than the original TRIKKE lithium-ion battery and charger can result in system failure. Any modification will void the warranty. Trikke Tech Inc. is not liable for injuries and/or death or any other damages caused by such changes.
- The Trikke EV vehicle is a lightweight, low-power electric vehicle, and may require the rider's help. Continuous turning right and left should be applied to help the engine while on a climb.
- The use of the electric motor will propel you to speeds you may not be accustomed to, and may be beyond your skill level. Begin by practicing at lower speeds for your own safety.



- The Trikke EV is an electric vehicle and as such there is potential for shock or fire, if the electrical system is tampered with or exposed to conditions of high humidity, causing possible short circuit or overload of the electric system. Electrical components must be protected from conditions of high humidity and physical damage.
- Using a charger other than the original Trikke charger can cause overheating of the battery and potential risk of fire.
- COMMON SENSE AND EDUCATION ARE VERY IMPORTANT IN THE OPERATION OF YOUR TRIKKE EV. DRIVERS SHOULD USE COURTESY WHEN USING AND SHARING THE ROADS AND SIDEWALKS. PEDESTRIANS ALWAYS HAVE THE RIGHT OF WAY. WHEN RIDING ON PUBLIC ROADWAYS, KEEP ON THE RIGHT SIDE OF THE ROAD AND REDUCE YOUR CARVING ACTION TO MINIMIZE CAUSING CONFUSION WITH THE OTHER DRIVERS ON THE SAME ROUTE.
- REMINDER: TRIKKE VEHICLES ARE DESIGNED TO RIDE FORWARD ONLY. PLEASE, DO NOT RIDE BACKWARDS AS THERE IS THE POSSIBILITY OF DAMAGING THE FRAME.

**Know the  
Trikke Pon-e**

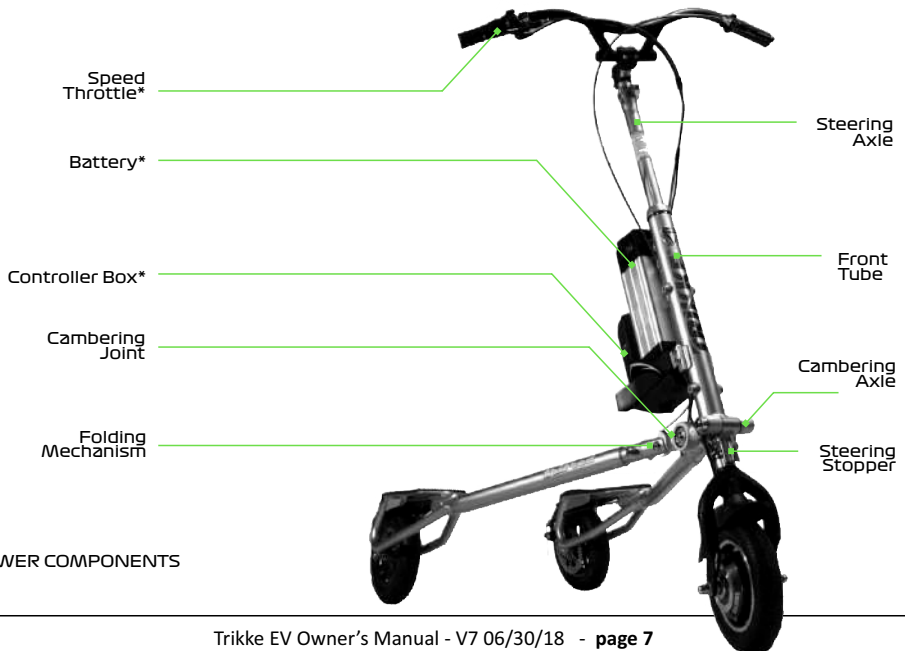
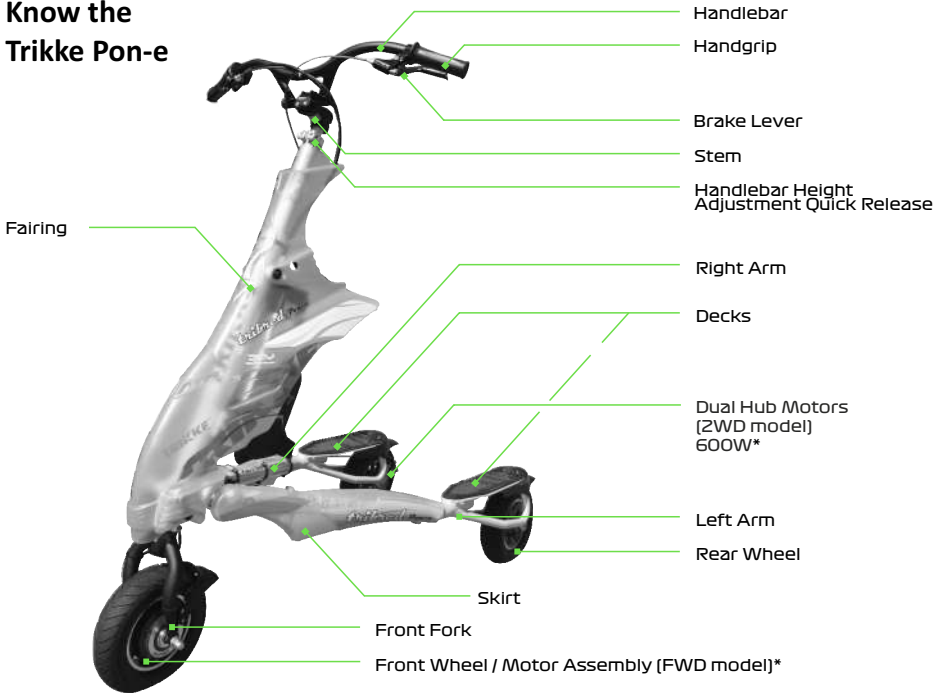

\* - POWER COMPONENTS

## Trikke EV - First Assembly

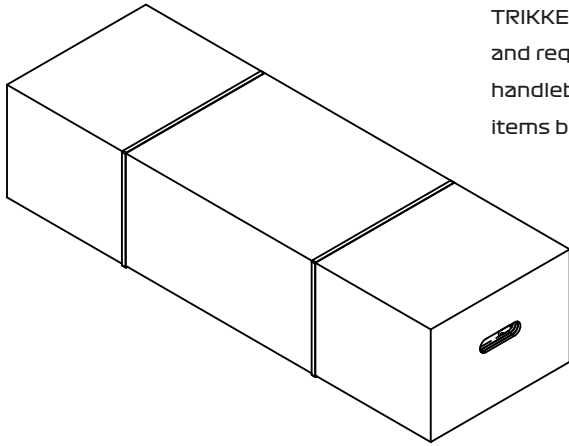

TRIKKE Pon-e comes pre-assembled and requires only the mounting of the handlebar and a quick check of some items before riding.

### Step 1: Unpack

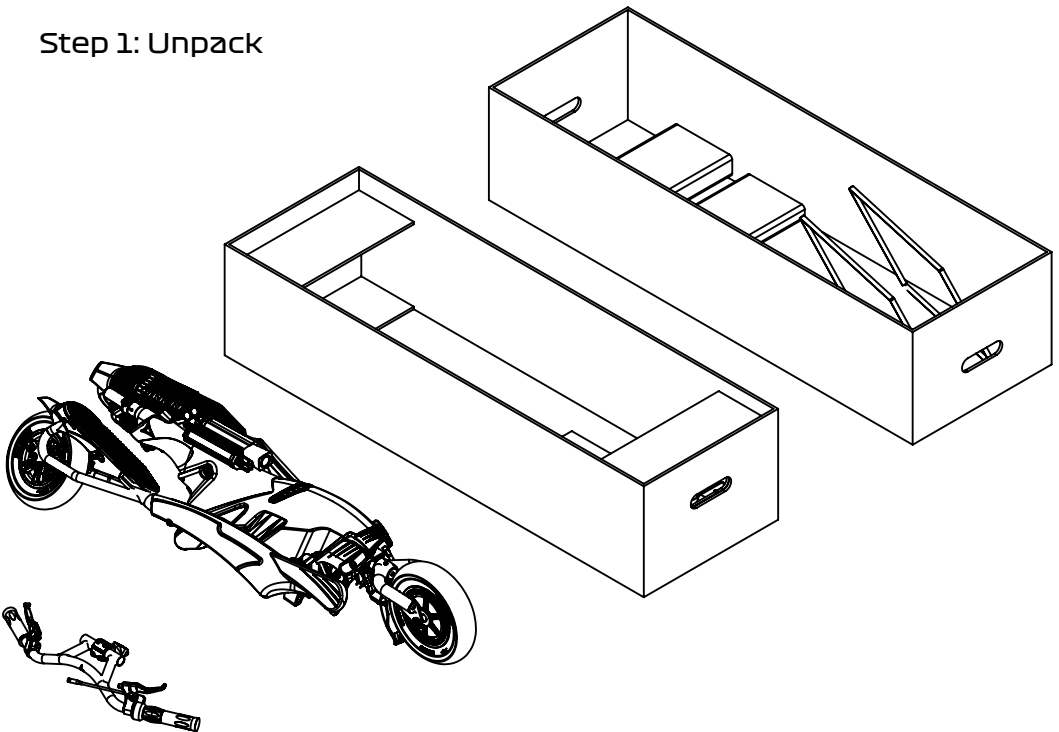



## Step 2: Unfolding the frame

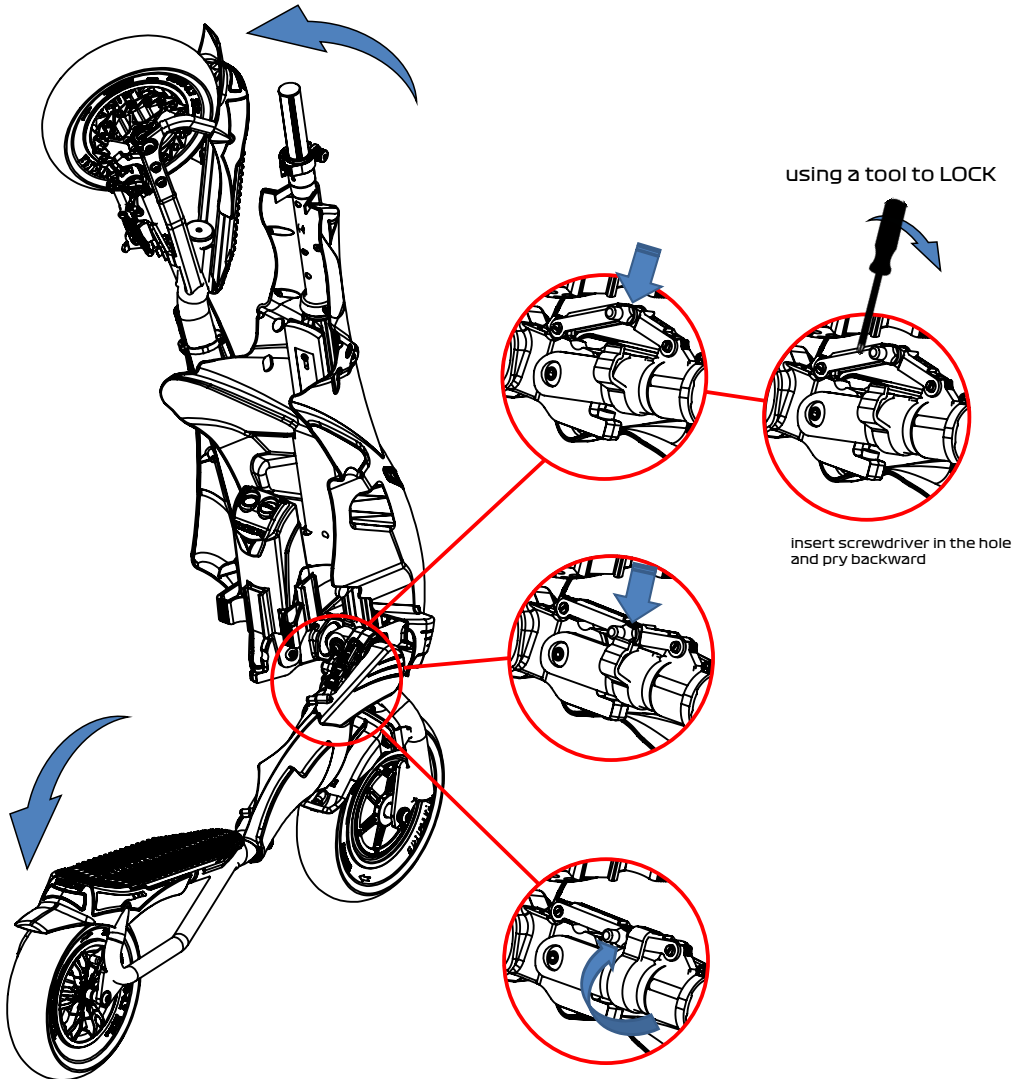



## Folding the frame

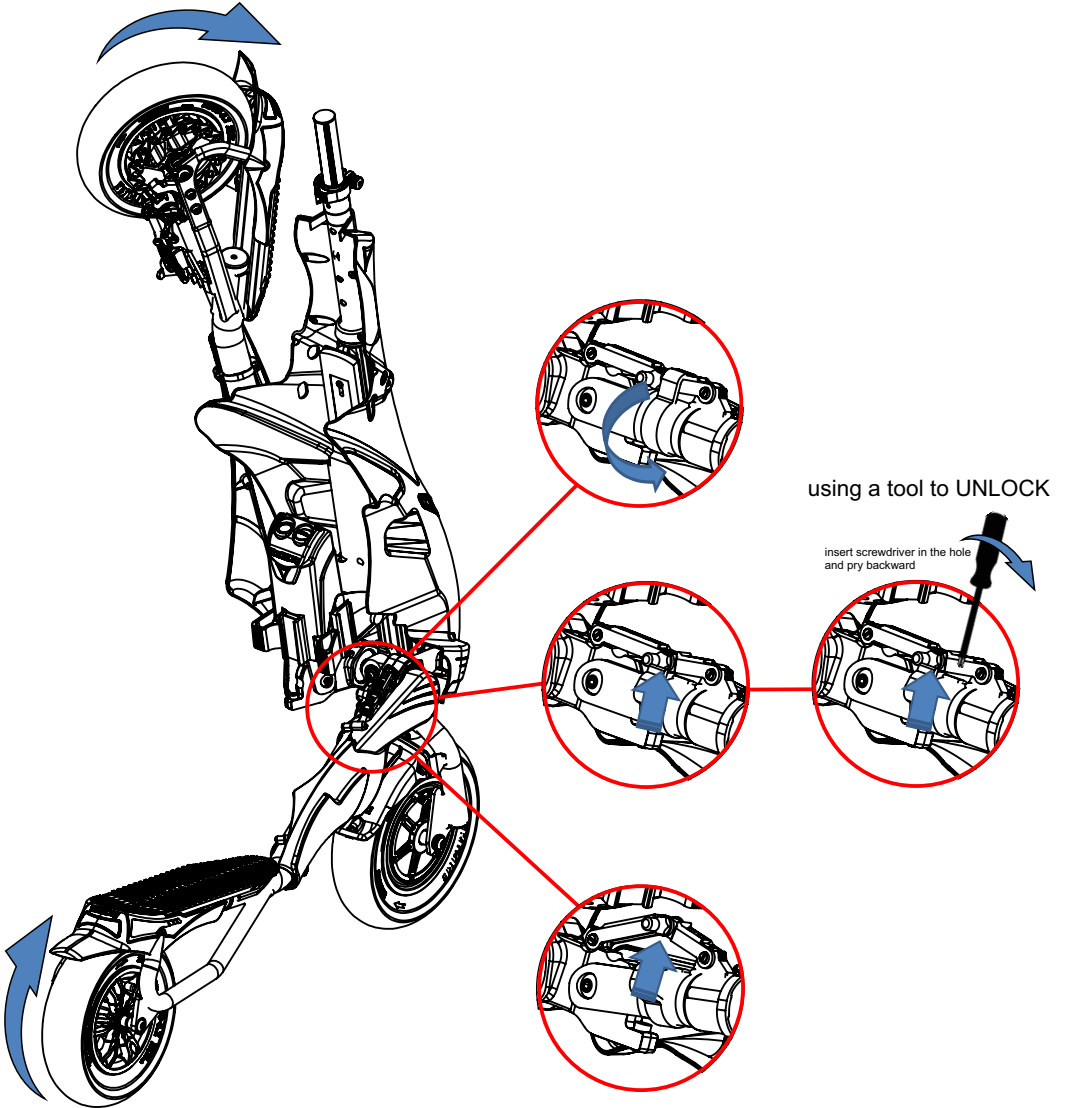

### Step 3: Attach and Align Handlebar

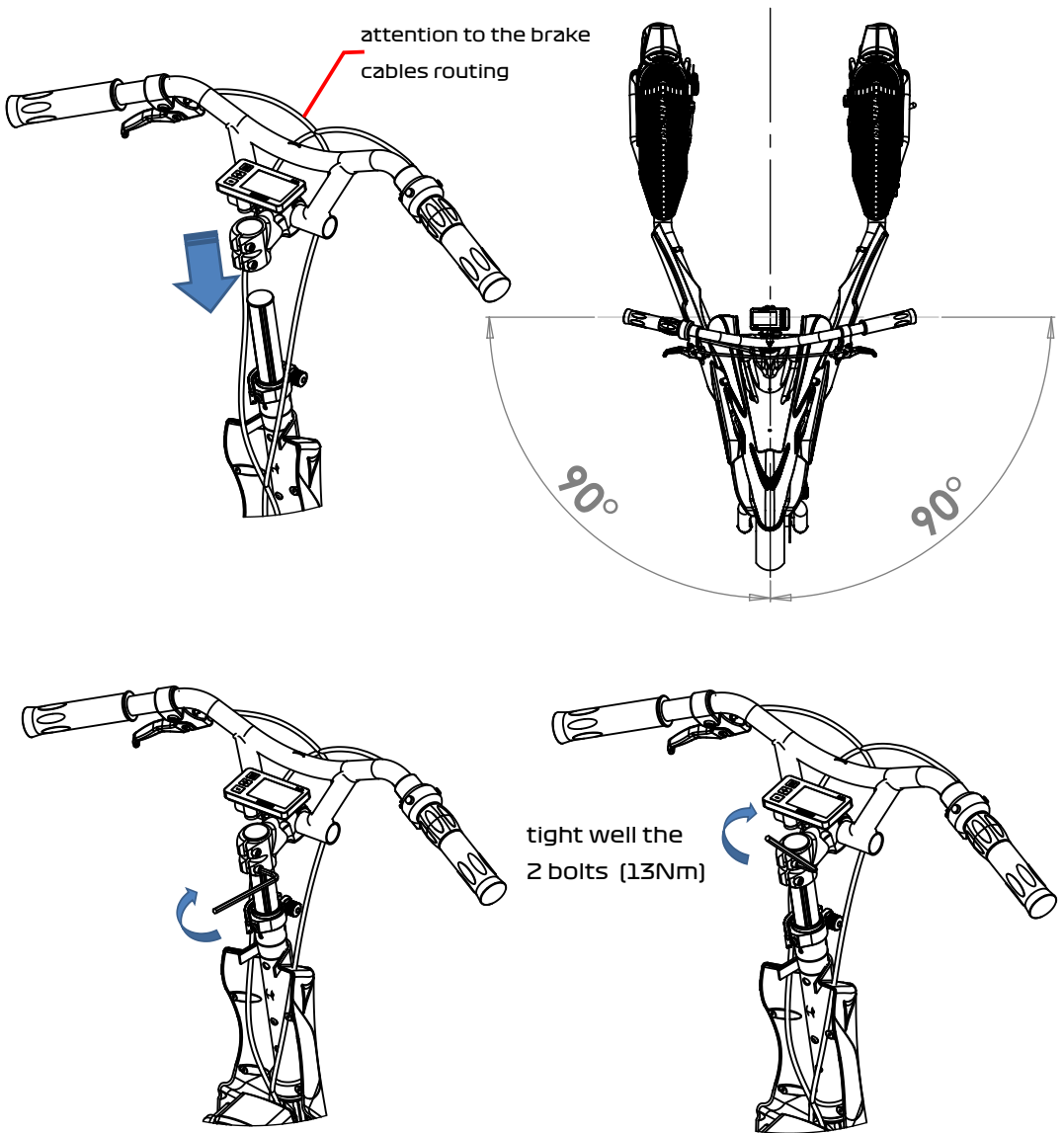

## Folding Mechanism Tension

If the folding lock mechanism feels too easy to lock/unlock, the tension must be increased by adjusting the cam axles as follow:

- a) set the folding in LOCKED position
- b) loosen the set screw with 2.5mm allen wrench.
- c) turn the cam axle inward to increase the tension of the mechanism.
- d) tight the set screw to lock the cam axle



Make sure the tension is kept very tight to guarantee there will be no play on the folding joint.

## Step 4: Adjusting Handlebar Height

To adjust the handlebar height, it is necessary to unlock the clamp. Note that there are holes in the back of the steering shaft establishing a number of positions for height positioning. There is a locking pin that fits these holes to provide a second level of security while driving. Push the locking pin to release the steering post and slide (up and / or down) to the desired height. Once positioned, close latch clamp, making sure it is securely locked.

If the clip is a little loose, tighten the adjusting nut manually. Adjusted properly, it

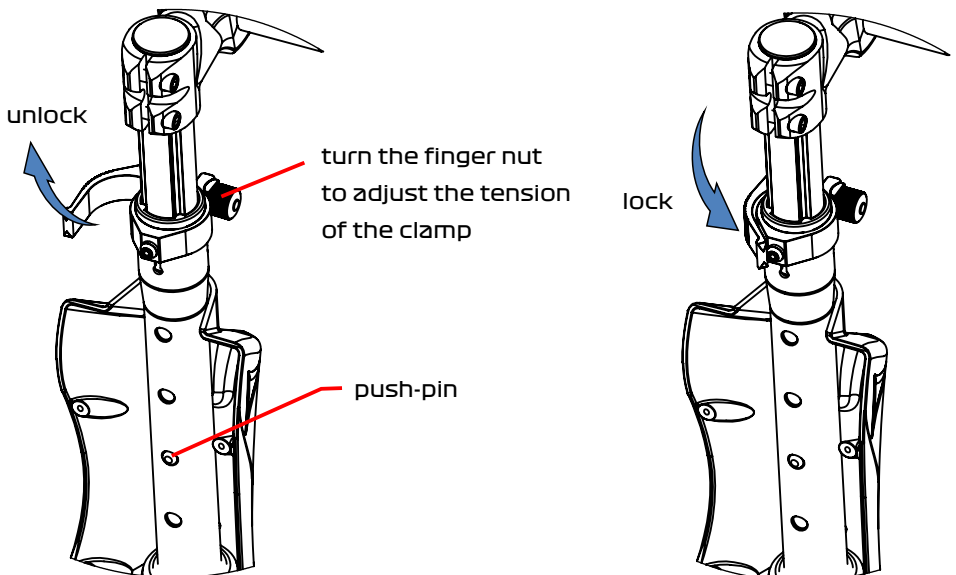

## Step 5: Tires Pressure

Trikke Pon-e is fitted with air inflatable tires. You will have to maintain proper pressure in the tires by regularly connecting an air pump with a gauge and pumping to the recommended pressure as indicated below.



"check tire pressure every 3 weeks".

40psi (2.8bar)

65psi (4.5bar)

Tire pressure affects energy consumption and battery range. Lower pressure makes a smooth ride, but will require more energy due to increased rolling resistance. Higher pressure reduces rolling resistance and increases mileage, but it makes a bumpier ride. Do not run with very low pressure, as this can damage the tires, negatively affect braking efficiency and increase the risk of a fall.

## Brake Adjustment

After some time of use, the brake pads will wear out and the brake will need to be adjusted tighter in order to work efficiently. Readjust the brake: a) outer pad (fine adjustment screw / stopper); b) inner pad (turn the back knob by finger or by using

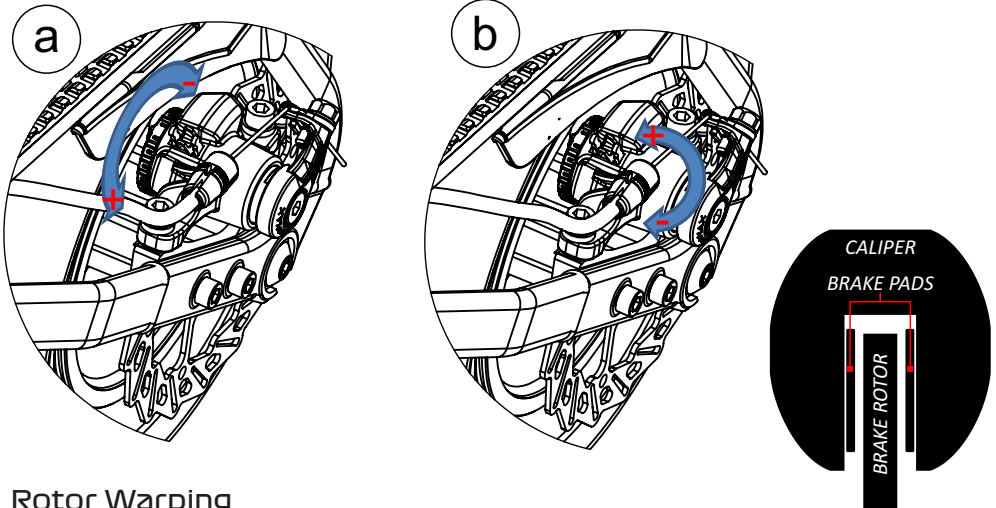

## Rotor Warping

Spin each wheel. If there is a visible warping on the rotor, mark where the rotor is off and use your fingers to bend the rotor in or out to straighten it. Repeat this procedure until the disk rotates without oscillations. [This is a common procedure, because the discs are thin and can deform easily. With use, and consequent increase in temperature, the disc tends to straighten itself].





## Step 6: Installing/Removing the Battery

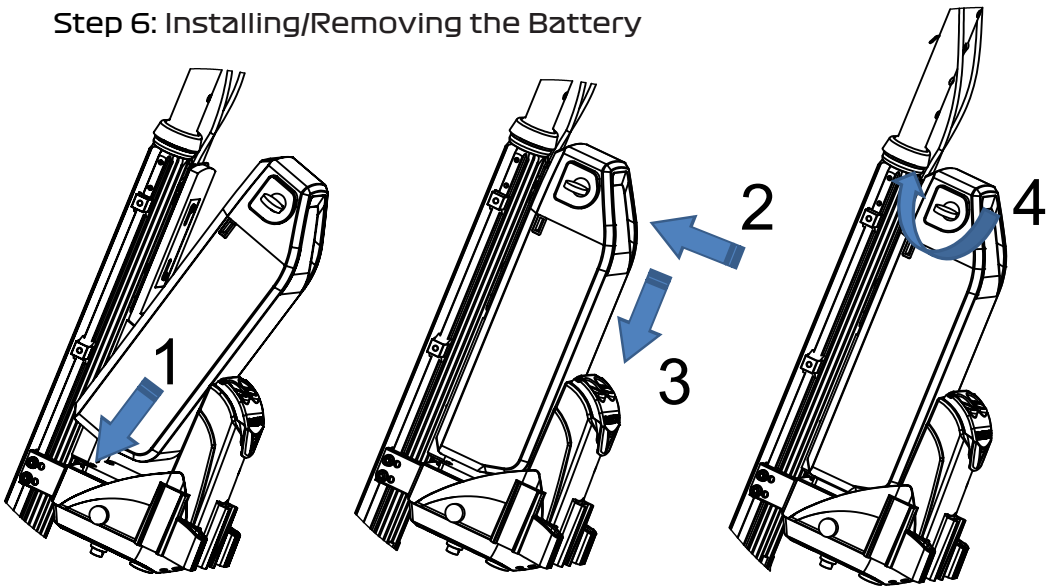

## Step 7: Pre-ride Check

When you complete the assembly process, check the vehicle again and compare it to the photograph on page 7.

Check the bolts that secure the front fork and handlebars. Push forward and pull back on the handlebars strongly; this should immediately indicate if it is securely fixed or not. Make a final check of the brake by turning the rear wheels. They should spin freely until you apply the brakes. It must be possible to vigorously squeeze the brake levers without the brake levers touching the handlebars. Check the folding mechanism to ensure that the arms are locked in the riding position. Use as reference the lever lock / unlock sticker on top of the folding mechanism.

## WARNING!

**Before riding the first time, please take a few minutes and review the Safety Riding Tips on pages 3-6 of this manual.**

**For the safety of friends and others who will try your new Trikke EV it is your responsibility to guide them how to ride safely. Make sure you have read and understood all warnings and safety information contained in this owner's manual before riding.**

**Please wear a safety helmet for riding.**

## Safety Issues

**FIVE WARNINGS WERE SELECTED FROM THE LIST AT THE BEGINNING OF THIS MANUAL FOR A MORE DETAILED DESCRIPTION. PLEASE READ AND UNDERSTAND THESE AND**

### Safety Warning 1: RIDING ON A WET OR SLIPPERY SURFACE

Avoid riding on wet or slippery surfaces (also surfaces covered by sand, gravel or mud) because the wheels may skid and braking distance can be affected causing loss of control and a possible crash. If necessary travel on slippery surface, try to travel in a straight line and avoid leaning the vehicle to maximize stability and control.

### Safety Warning 2: WEIGHT DISTRIBUTION



When accelerating, it is important to place the weight on the front wheel, as shown in the picture, keeping most of your weight on your toes, feet positioned in front of the platform. This will ensure good traction of the front tire.

Once you and your Trikke EV are in motion, return to your normal posture. Be careful not to lean too far back or shift your weight behind the rear wheels. This warning is especially important for drivers who do not have

good coordination, or are slow to react to an unexpected event.

To brake more effectively, shift your weight back over your heels, over the rear wheels, as shown in the picture, but be careful not to lean too far back. Apply both brakes simultaneously (Trikke EV has independent brakes on rear wheels left and right respectively actuated by levers on the handlebars left and right). Distributing your weight evenly over each rear wheel is crucial for maximum braking efficiency. If you take the weight off of the platforms during braking you will cause the wheel to lose contact with the ground and lock.

The best way to ensure you are always well positioned and to minimize the risk of the vehicle pull a wheelie, is to distribute your weight evenly between the front and rear wheels, keeping your weight on your toes and putting your feet up to the front of the platforms.



Avoid leaning too far over the handlebars - the rider must maintain balance on their feet, not leaning on the handlebars. The legs should be slightly bent to absorb impact, balance the body and ensure constant contact with the platforms.

Avoid leaning your body back, supporting yourself on your heels, stepping behind the center of the rear wheels and pulling the handlebars back, because this way you will inevitably reduce the weight of the front wheel losing traction and control, and you may fall back and have an accident.

Another reason for a balanced weight distribution is to ensure a better use of traction (front and rear tires) with no spinning or skidding during acceleration and braking.

### **Safety Warning 3: BEHAVIOR OF THE RIDER**

Proper use of the handlebars, and especially how to push it to the left and right is vital for your safety. Because the front wheel is designed to trail the fork, the handlebar tends to turn in the direction you tilt the vehicle. Unlike a bicycle, which tends to follow a straight line, the front wheel will actually accentuate the turn. Because of this condition, less experienced riders should pay special attention while driving. Turning the handlebars too far, and allowing the front wheel to move quickly to the side, may cause the vehicle to stop suddenly ("jack-knifing"), throwing the rider from the vehicle, which may cause injury. Always maintain firm control over the handlebars with both hands, never drive with just one hand or no hands. The Trikke EV requires both hands on the handlebars at all times.

Beginner riders have a tendency to apply excessive force on the handlebars, making sudden movements, throwing their weight from one side to another. What propels the Trikke forward manually is the leaning of the vehicle, a combination of turning and leaning of the steering column, and not just pushing the handlebars from side to side. It is better to think in terms of more leaning and less turning. Motion and trajectory in large "S" turns are best for beginners.

### **Safety Warning 4: DOWNHILL**

As the Trikke EV is a totally new machine, with a unique handling, we recommend that you take time to familiarize yourself with the vehicle and to gradually explore the limits of performance with each ride.

This is especially important before attempting climbs or steep descents. Riding uphill and downhill are advanced and require you to be fully competent before even trying. On descents, we strongly recommend that you only go down slopes on which you can



Control the speed by turning. Riding on hills at speeds that require constant braking are not recommended for three reasons: you can reach speeds where the braking distances needed are too long to stop you safely, and you may fall at high speed causing serious injury or death, and you will simply wear out the brake pads and rear tires long before their expected life expectancy.

The Trikke EV will accelerate quickly, so try to ride at speeds appropriate to your skill level.

## **Safety Warning 5: SAFETY EQUIPMENT**

ALWAYS USE SAFETY EQUIPMENT, ESPECIALLY A HELMET. A helmet is essential when riding a Trikke EV or any exposed wheeled vehicle. We also recommend that you wear gloves, elbow and knee pads, especially children and inexperienced riders. Although it is a stable platform, there are always conditions that vary with the environment, which may surprise you, such as cracks in the pavement, sand, gravel, potholes, tree branches, people or other vehicles. Falls and accidents can occur.

Driving at night should be avoided, but in case of night time use we recommend the use of headlamps and signal lights on front and rear. See and be seen.

Also the use of horn or bell helps you call attention and be noticed.

**READ AND UNDERSTAND THE SECTIONS OF ASSEMBLY,  
MAINTENANCE AND SAFETY MANUAL BEFORE RIDING.  
ALWAYS FOLLOW THE INSTRUCTIONS AND READ ALL**

Visit our website at [www.trikke.com](http://www.trikke.com) if you want to buy safety gear (helmet, gloves, knee and/or elbow pads).

## Riding Range

1. The possible distance per ride (mileage) of Trikke EV depends on many things, including the topography of the terrain, the rider's weight, direction and speed of the wind, temperature, throttle usage, assistance with body propulsion, tire type and pressure.

2. To extend the riding range of the Trikke EV, avoid long or steep climbing, help the vehicle as much as possible with body propulsion and use the throttle sparingly, and keep tires inflated to the recommended pressure.

### Vehicle Operational Limits

Rider's weight: max 113kg (250lbs)	Climbing: max 5 degrees
Downhill: max 10 degrees	Speed: max 40km/h (25mph)
Riding surface: smooth and good traction asphalt or concrete (not for uneven rough pavement, off-road, slippery surface);	
Weather: light rain; not for use under heavy rain.	
Temperature: 0 to 40°C (32-104F)	

## Vehicle Operation

- 1) Switch the battery power ON (battery rocker switch). The display will power ON and you are ready to go!
- 2) Mount on the Trikke, grip your hands tight on the handlebars.

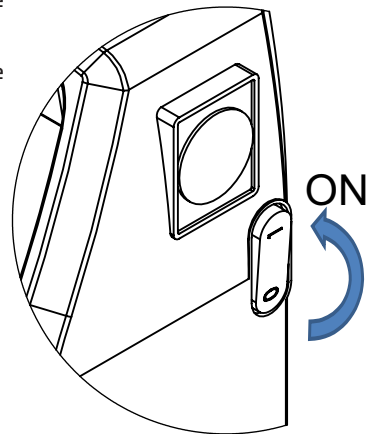

3. To run the motor just turn the throttle back, like on a motorcycle (using the thumb and forefinger). The accelerator is sensitive and must be rotated to progressively increase the torque and speed. Be careful at the start cranking the throttle slowly until the vehicle starts to move. Lean your body forward and step in front of platforms forcing your weight onto your toes. Once in motion, distribute your weight evenly between the front and rear wheels. When moving, you can turn over the throttle to increase speed and control. Avoid burning of rubber (spinning the motor freely) at the start to not leave marks on the floor and prevent premature tire wear.



4. Avoid starting with the handlebar turned, since you can lose balance and fall. Start with the front wheel aligned forward and then initiate the turn of the handlebars once already in motion.

5. When crossing the street, you will need enough time for a slow acceleration. Be wise and consider the time required for the crossing. You can always walk the vehicle or give a push to the ground for a quicker start.

6. Riders should consider the need for a generous distance to reduce speed (or stop) when riding at high speed. Avoid riding on wet or flooded surface. The Trikke EV can withstand a small amount of moisture, however, is not recommended for continuous use in rain or wet. In the case the vehicle gets wet, remove the battery and keep it in a dry and ventilated environment to dry the components. Avoid using the Trikke EV with wet parts.

7. Avoid impacts that can damage the motor, brackets, battery, and the frame. For example, going at speed over potholes, bumps, curbs or any obstacles.

8. When you're climbing, it is important to assist the motor by riding in a "S" path. This is comparable to using a lower gear to avoid overloading the motor.

9. The Trikke EV automatically stops the power supply to the motor if the motor is stuck and cannot rotate. An example would be to put the front wheel against a wall and press the accelerator. Another example would be the motor stalling when climbing a steep ramp. The motor will not turn, even with the power being supplied. This action will cause the electronic controller to disarm. Once the throttle is returned to the starting position, the system starts working again. Avoid overloading the motor repeatedly because the electrical components will overheat and possibly it will be damaged permanently.

10. Operation at very high external temperatures can cause the electronic motor controller to disarm or fail intermittently. When cooled, the system will function normally again. This is a thermal protection to avoid damage to electronic components. The controller is located inside the tower behind the battery. Do not obstruct the cooling vents for the motor controller.

11. When the batteries are almost empty, there will be a pause, and intermittent power will be supplied to the motor until the battery shuts down permanently. Battery will need to be re-charged.

12. Charging the battery:

To charge the battery, first plug the charger to the entrance located next to the charging port on the battery top cap. Then plug the power cord from the charger to a 110V ~ 220V 50 ~ 60Hz power outlet.

When the battery is charging, the charger light stays red. When the battery is fully charged, the charger light turns green. Note that when the charger is disconnected from the battery, the charger will turn green too. Green light can also mean a bad connection. Good practice would be plugging in the battery at every opportunity and keep the battery always with a good level of charge.

Always disconnect the power cord and charger pulling by the plug, not the cord.

Unplug the charger when not in use.

5 hours and 0.7 kWh are necessary to fully charge a discharged battery 48V-11.25Ah.

The lithium-ion battery included with the Trikke EV has a useful life of 500 complete cycles of operation with a performance above 70% of original capacity. A complete cycle is one complete discharge and recharge.

### 13. Battery Operation:

Rock the power switch up to turn power ON, and down to turn the power OFF.

Charge the battery by plugging the charger plug connector to the battery's charging port.

For longer life of the battery, charge the battery every time you can, avoid deep discharge (using until it's empty or keeping the battery discharged for long period).

Operation in low speed will also contribute to a longer life of the battery. Hot or cold weather will decrease the capacity of the battery.

Store the battery in a dry place. If storing for long time, plug the battery to the charger once every 90 days for 3 hours.

Check the battery charge by pressing the dot on top of the battery which will light up to 4 dots to show the battery charging level from 0-100%. SOC (state of charge) must be checked under rest (with no load from the motor).

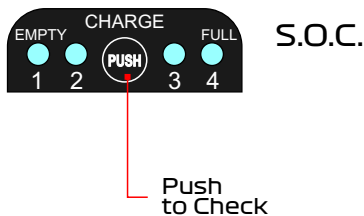



**Battery**

**S.O.C.  
label**



push button to display

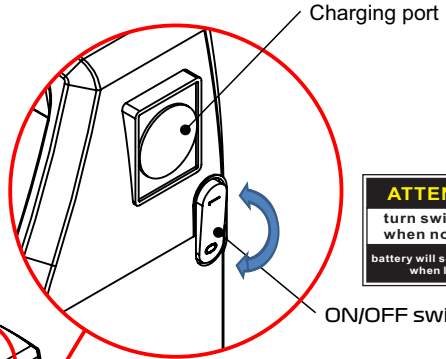

**ATTENTION**  
turn switch **OFF**  
when not in use  
battery will self discharge  
when left ON

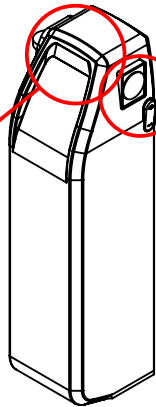
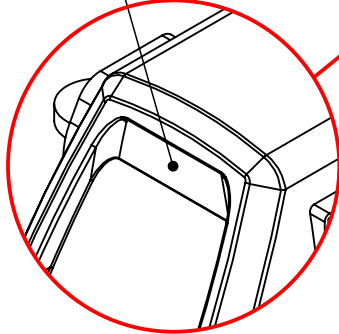

**CAUTION**

- Use only the original charger
- Unplug charger after battery is fully charged
- Do not leave battery fully discharged
- Protect battery from moisture or rain
- Do not expose to heat
- Store in a dry and cool place
- Long term storage: charge every 90 days
- Check for transport limitations on Li-ion batteries
- Dispose properly. Take to a battery recycling center
- Read warranty terms and conditions.
- Read battery manual

**Lock Key**

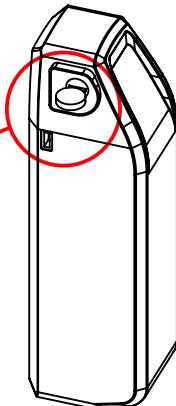
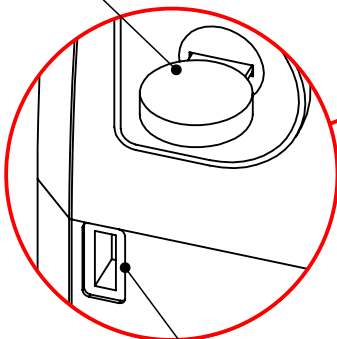

**Li-ion Battery**  
48V  
14.5Ah / 696Wh

**CAUTION**

- \* DO NOT SHORT CIRCUIT
- \* USE ORIGINAL CHARGER ONLY
- \* MAY EXPLODE IF DISPOSED IN FIRE
- \* DISPOSE PROPERLY. RECYCLE.
- \* RESTRICTED FOR AIR TRANSPORT
- \* UN3480

13Ah/624Wh  
11.25Ah/540Wh

## 14. LCD Display Operation:

Turning Display ON-OFF and sleep.

After switching the battery power ON you will have to press **M** button to turn the display ON and start the system.  
 To turn the system OFF press and hold **M** button. You may also switch the battery power OFF. After a preset time of non-operation, the display will turn OFF by itself (sleep).  
 Press **M** to wake the system up.

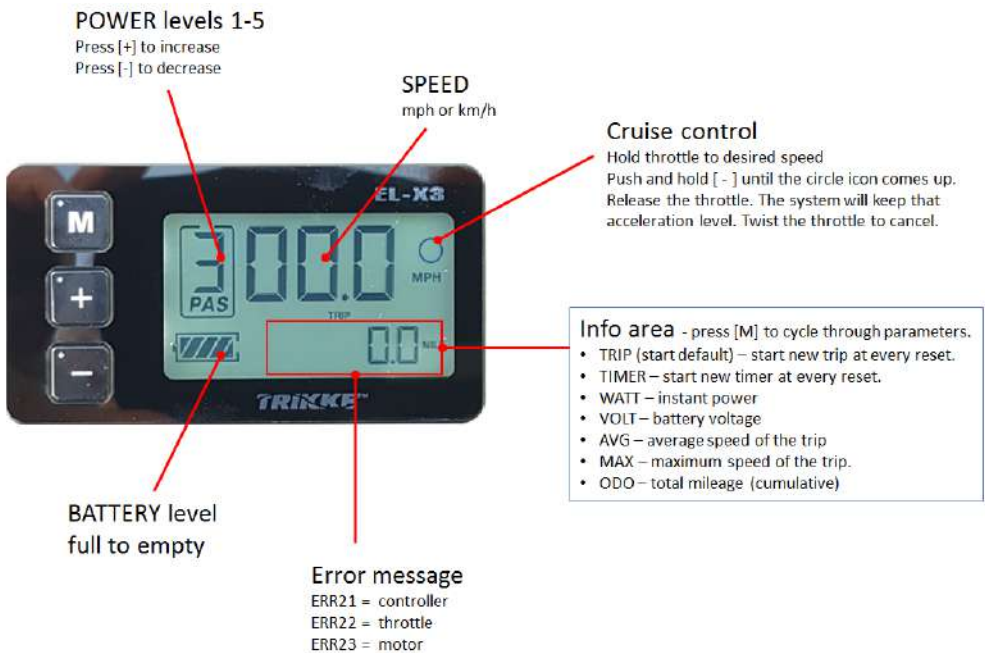

## Parking

1. The Pon-e has parking brakes to keep it still and balanced. In the two manual brake levers there is a pin that locks the actuated lever.

Squeeze the brake lever all the way and push down the lock pin with the index finger.

Release the brake lever after pressing the pin down so that the tension of the brake lever will keep the lock-pin triggered.

To release the brake, squeeze the brake lever and the lock-pin will jump and release from the locked position.

2. Preferably, find a flat surface for parking. If the parking spot is in an incline, point the front wheel up or down the slope. Do not park across the ramp.

3. Try to find a shoulder or lip to rest the front wheel against, in order to prevent unexpected movement due to the incline. Lock the parking brakes for safety.

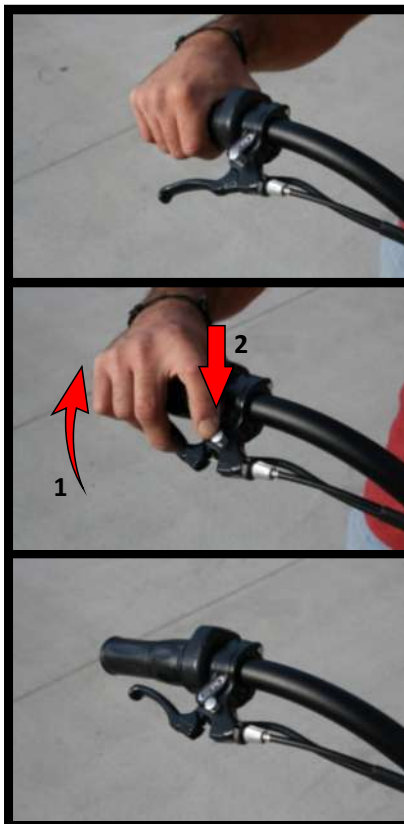

## Changing Display Settings

Press and hold [+] and [-] simultaneously for 2 seconds to enter Settings.

Press [M] to cycle through parameters P01 ~ P14

Press [+] or [-] to change value

\*\* careful to not change factory default parameters if you are not sure of the values.

Press and hold [+] and [-] simultaneously for 2 seconds to save changes and leave settings.

## Useful settings:

a) Speed limiter P01 -> example ZWD model 100 = top speed (23mph) ; 50 = 50% of the top speed (11.5mph)

b) Time out P06 -> minutes to sleep

c) Starting power P07 -> 1-5.

## Turning Display ON-OFF and sleep

After switching the battery power ON you will have to press M button to turn the display ON and start the system.

To turn the system OFF press and hold M button. You may also switch the battery power OFF.

After a preset time of non-operation, the display will turn OFF by itself (sleep).

Press M to wake the system up.

PARAMETER	description	range	Factory value
P01	Speed limiter	0-100%	100
P02	Motor magnets count	20 (2WD); 30 (FWD)	20 / 30
P03	Tire circumference	753 (2WD); 835 (FWD)	753 / 835
P04	unit	Miles ; Km	
P05	System voltage	36V ; 48V	48V
P06	System timeout	1-30 minutes	15
P07	Number of motors	1 (FWD); 2 (2WD)	1 or 2
P08	Speed sensor	1 (motor); 0 (external)	1
P09	Odometer reset	1 ; 0 will reset to zero	1
P10	Start power assist	5-Jan	3
P11	Not used		0
P12	Immobilizer (motor jamming)	0 – off ; 1 - on	1
P13	Not used		0
P14	Not used		0

## Maintenance

### Tires

The tire pressure should be checked and maintained within the recommended pressure range for safe and optimal performance.

Visually inspect tires for damage or uneven wear. Note: it's normal that the front tires will wear on the center and have a flatter shape as it wears off. The rear tires will wear mostly on the inside of the thread area due to the natural cambered geometry. Tires must be replaced if it presents uneven wear on circularity ; or the remaining threaded area is less than 50% of the original.

### Replacing Tires

1. Remove the wheel from the fork and take it to a workbench with a vise to hold and lock the wheel axle while you work on it. ZWD model must unplug and release the motor cable from the fork by cutting the zip-ties.
2. It is recommended to use a tire lever appropriate to remove the tire from the wheel. A lever helps prevent damage to the rim
3. Use petroleum jelly (Vaseline) to help the process of removal and mounting of the tire. Make sure the inner tube isn't twisted inside the tire.
4. Once the tire is replaced, fill it with low pressure to center the tire to the rim, and then calibrate with the recommended pressure. Re assemble the wheel to the fork positioning. Make sure to keep the air valve stem very short by pressing it inside the tire while inflating (and it should retain this low profile when fully inflated). This is important because a long valve stem will hit the fork not letting the wheel to turn freely.
5. Make sure that the axle wheel is pushed firmly against the fork to the bottom of the notch. Notice the flat areas on the shaft and align with the flat areas of the notch of the fork.
6. The washers have a locking small projection (tooth) to fit in the notch of the fork. These projections help to lock the axle in the fork to prevent rotation.
7. Tighten the bolts with a 5mm allen wrench to a torque of 18 Nm.

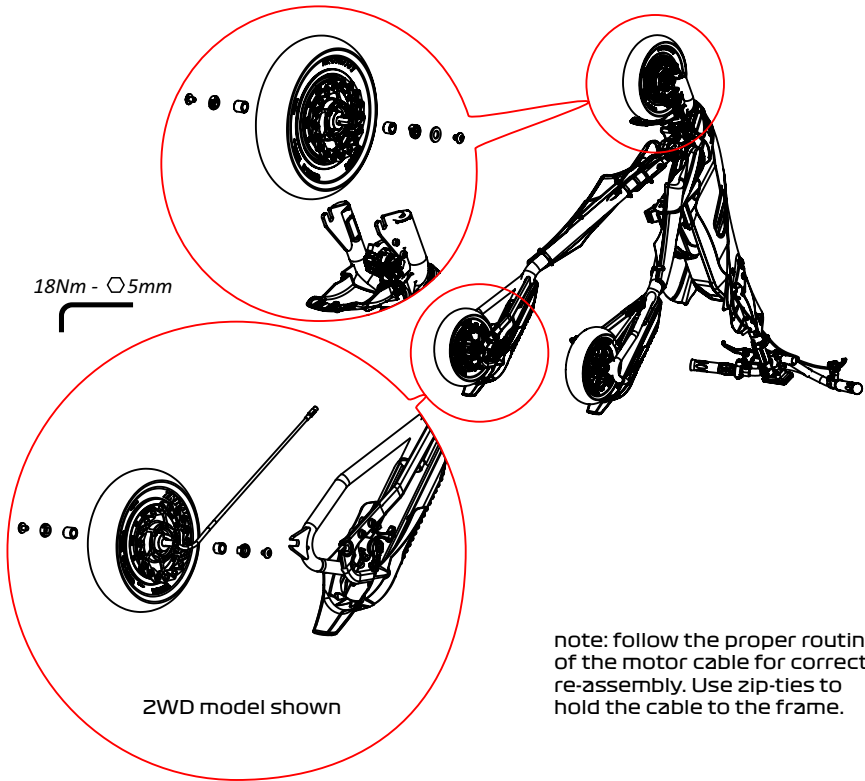

### Re-attaching the Motor Cable

The motor cable must be re-attached to the front fork using 3 plastic zip-tie.

The cable must be inserted in the spiral bracket, leaving a "slack" (tummy) between the fork and the bracket to allow the side-to-side movement of the fork. The connector must then be firmly re-connected to the bottom of the controller box.

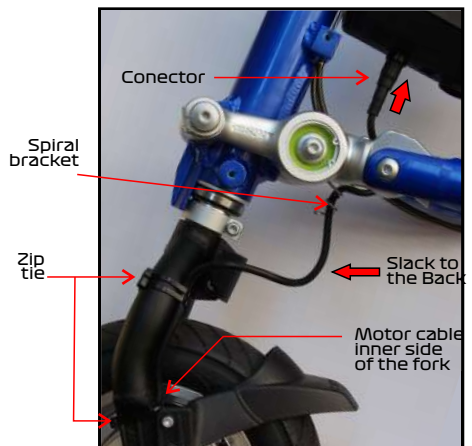

FWD model shown

## Troubleshooting Electric Issues

ISSUE	CHECK	POSSIBLE CAUSE/SOLUTION
<p>1. Display won't come on when battery is switched ON.</p>	<ul style="list-style-type: none"> <li>• Check battery charge. Make sure battery has correct voltage on the bottom connectors (POS-NEG). Use a voltmeter to check.</li> <li>• Check connectors and cables: battery to controller, controller to display</li> </ul>	<ul style="list-style-type: none"> <li>• faulty or discharged battery</li> <li>• damaged or disconnected cables</li> <li>• faulty display</li> <li>• Try replacing controller.</li> </ul>
<p>2. The display turns on, but the motor doesn't work when twisting the throttle.</p>	<ul style="list-style-type: none"> <li>• Make sure the cable from the motor to the controller is properly connected.</li> <li>• Visually check the motor cable for damage.</li> <li>• Throttle cable and connector</li> </ul>	<ul style="list-style-type: none"> <li>• Try replacing throttle.</li> <li>• Try replacing controller.</li> <li>• Try replacing display</li> <li>• Last, replace the motor if not solved by above.</li> </ul>
<p>3. Motor applies intermittent power (stutters) and/or makes intermittent noises.</p>	<ul style="list-style-type: none"> <li>• Make sure the cable from the motor to the controller is properly connected. Force it into confirm.</li> <li>• Visually check the motor cable for damage.</li> </ul>	<ul style="list-style-type: none"> <li>• Motor cable, motor or controller may be damaged internally.</li> <li>• Try replacing controller.</li> <li>• Try replacing motor.</li> </ul>
<p>4. Charger doesn't turn red to start charging (stays green all the time, no charging occur).</p>	<ul style="list-style-type: none"> <li>• Inspect charger cable and connector.</li> <li>• Wiggle connector while attached to the battery</li> </ul>	<ul style="list-style-type: none"> <li>• Faulty charger - try with another charger</li> <li>• Faulty battery</li> </ul>



## Specifications

Pon-e FWD

Pon-e ZWD

### FRAME

Weight	46lbs / 20.5kg (with battery)	66lbs / 29kg (with battery)
Frame	6061 T6 Aluminum with Patented High Performance 3CV Cambering System and Folding Mechanism	
Brake	Dual Disc Brakes on Rear Wheels	All Wheel Disc Brake
Wheels	Alloy Rim with Abec5 Sealed Bearings	
Tire - Front	65/85-6 Inflatable with inner tube Heavy Duty Hi-Pressure Inflatable Tire	
Tires - Rear	65/80-5.2 Inflatable with inner tube Heavy Duty Hi-Pressure Inflatable Tire	

### ELECTRIC

Battery	48V 11250mAh 540Wh Li-Ion with 18650 cylindric cells	48V 14500mAh 694Wh Li-Ion with 18650 cylindric cells
Charger	54.5 2A CV/CC	54.5 3.5A CV/CC
Charge time	5h	4h
Motor	Direct Drive 48V 350W 550rpm	Dual Direct Drive 48V 600W 1000rpm
Controller	Sine-Wave 15A	Dual Sine-Wave 12A
Speed Throttle	1/3 Twist Grip on Handlebar	

### PERFORMANCE

*Speed	max 17mph - 27km/h	20mph - 32km/h
**Range	up to 20 miles - 32km	up to 25miles - 40km

\*Speed and acceleration will vary with rider's weight. \*\*Range will vary with topography, rider's weight, wind, riding style (carving assistance), . Tires must be inflated to max recommended pressure. Ranges listed above depict an average with a rider weighing 200lbs (90kg).

### FEATURES

- Folding Frame
- Adjustable Handlebar Height
- Quick-Swap Li-Ion Battery/Locking Feature
- Parking Brakes



## Dimensions

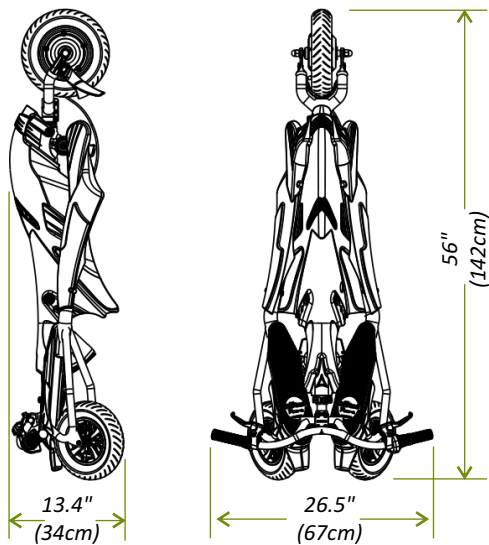
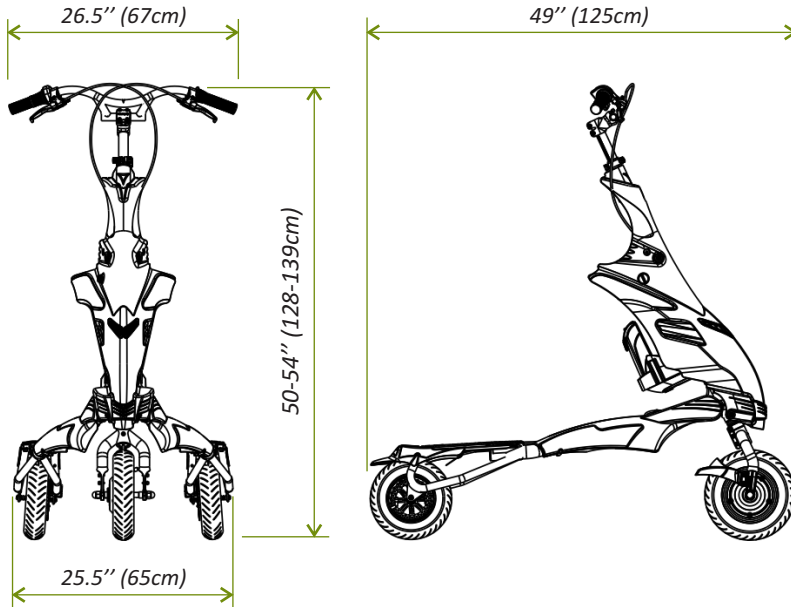

### Trikke Accessories

Trikke offers the following accessories:

#### Protection Gear:

- Helmet
- Knee and elbow pads
- Gloves

#### Safety:

- Headlight
- Blinking light
- Anti-theft cable lock

#### Transportation:

- Bag holder
- Glove box
- Towing trailer

#### Electrical Accessories:

- Spare Battery
- Spare charger
- Car charger (from 12V DC)

#### SPARE PARTS:

Use only original TRIKKE parts for guaranteed performance.  
Parts manual is available at [trikke.com](http://trikke.com) website.



## Trikke EV Limited Warranty

Subject to the following limitations, terms and conditions, Trikke Tech, Inc. ("Company") warrants to the original owner of each new vehicle Trikke™ Trikke EV ("Vehicle") that the vehicle when new is free from defects in material and workmanship. This warranty is valid for 12 months from the date of purchase from the Company or an authorized dealer or representative. This warranty is conditional on the vehicle being operated under normal use and properly maintained according to the plan established by Owner's Manual. This warranty is void if the vehicle has not been purchased from an authorized Trikke dealer, not followed the periodic maintenance in accordance with the plan, or for abuse or misuse. The Owner's Registration Card must be completed at the time of purchase by dealer and a Warranty Certificate will be issued to the first owner. If the vehicle frame breaks due to faulty materials or workmanship within the warranty period, the vehicle may be replaced subject to the Conditions of Guarantee. If any part do not function properly due to defects in material or workmanship during the warranty period, this piece will be repaired or replaced at the discretion of the Company, subject to the warranty conditions below.

## Warranty Conditions

This Limited Warranty is made only to the original owner of the new Vehicle purchased from Company or an authorized dealer or representative, and it shall remain in force only as long as the original owner retains ownership of the Vehicle. This Limited Warranty is not transferable.

This Limited Warranty is issued to the original owner of a brand new vehicle purchased from the Company or an authorized dealer or representative, and shall remain in force as long as the original owner retains ownership of the vehicle. This Limited Warranty is not transferable. In order to exercise its rights under this limited warranty, the warranty must be submitted during the warranty period, to the company or one of its authorized representatives, along with the sales invoice or other documentary proof of purchase. The owner will be responsible for costs related to return and delivery of the vehicle to the Company or its authorized reseller. Under no circumstances this warranty covers the cost of shipping the vehicle to the dealer. The Company will cover the cost of labor and parts necessary to repair the vehicle warranty. This limited warranty does not apply to normal wear or of any defects, malfunctions or failures resulting from abuse, neglect, damage caused accidentally or deliberately, exceeding weight limits, improper operation, improper maintenance, alteration, collision, accident or misuse or abuse. The vehicle was NOT conceived, designed, distributed, manufactured or sold for use in stunts, jump ramps, jumps, drive aggressively, use on uneven terrain or off road, submersion in water, use in harsh climates, loaded over the weight limit, commercial activities, or any similar activities. Such uses may damage the vehicle, can cause serious injury to the rider, and in all cases will void this warranty. The user assumes all risks of physical injury, vehicle breakdown, loss or personal injury caused to third parties or related to the use of the vehicle.



## Product Life Cycle

The Trikke™ Trikke EV vehicle has a lifecycle. The duration of this cycle varies with the maintenance and care received during their time of use, and the type and amount of use that the vehicle is subjected. The vehicle must be inspected periodically by observing indicators of fatigue and other indicators of potential problems. These are very important safety checks to help prevent accidents, injuries to the rider and shortening the lifecycle of the vehicle.

THIS IS AN INTEGRATED AND FINAL STATEMENT OF TRIKKE'S LIMITED WARRANTY. COMPANY DOES NOT AUTHORIZE OR ALLOW FOR ANYONE, INCLUDING ITS AUTHORIZED DEALERS OR REPRESENTATIVES, TO EXTEND ANY OTHER WARRANTIES, EXPRESS OR IMPLIED. NO OTHER REPRESENTATION AND NO STATEMENT OF ANYONE BUT THE COMPANY, INCLUDING A DEMONSTRATION OF ANY KIND BY ANYONE, SHALL CREATE ANY WARRANTY REGARDING THE TRIKKE CAMBERING VEHICLE. ALL OF THE REMEDIES AVAILABLE TO THE ORIGINAL OWNER ARE STATED HEREIN.

IT IS AGREED THAT TRIKKE TECH, INC.'S LIABILITY UNDER THIS LIMITED WARRANTY SHALL BE NO GREATER THAN THE AMOUNT OF THE ORIGINAL PURCHASE PRICE AND IN NO EVENT SHALL TRIKKE TECH, INC. BE LIABLE FOR INCIDENTAL OR CONSEQUENTIAL DAMAGES.

## DISCLAIMER

All other remedies, obligations, liabilities, rights, warranties, express or implied, arising from law or otherwise, including but not limited to, any claimed implied warranty of merchantability, any claimed implied warranty arising from course of performance, course of dealing or usage of trade, and any claimed implied warranty of fitness, are disclaimed by Company and waived by the original owner.

Some states, jurisdictions, countries, do not allow some or all of the limitations set for herein, or the exclusion or limitation of incidental or consequential damages. If any provision is found unenforceable, only that provision shall be stricken and all others shall apply. This limited warranty does provide the original owner with certain legal rights and recourse and the original owner may possess other rights or recourse, depending on the state, jurisdiction,

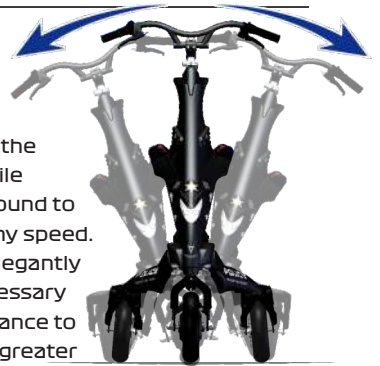

## TRIKKE TECHNOLOGY

The unique 3CV technology developed by Trikke Tech uses a mechanism that allows the Trikke EV frame to cambering and the suspension to adapt to the the surface and lean into turns while keeping three points of support always in contact with the ground to ensure optimal stability at any speed.



This camber mechanism is elegantly simple and provides the necessary rigidity, geometry and assistance to the rider's motion to allow a greater control, speed, comfort, durability and above all the full confidence of riding.

## Patent & Trademark Information

The Trikke EV vehicle is a product developed, patented and property of Trikke Tech, Inc. protected by the following International Patents:

U.S. 6,220,612, 6,499,751, 6,827,358, 6,976,687; 1235709 Europe, Canada 2,390,224; China 2L 00 8 18040.7 - Other patents pending.

TRIKKE and Trikke EV are trademarks of Trikke Tech, Inc.

## Contact Information

Most inquires can be addressed by the authorized dealer, distributor and service center. You can also find additional information on our website with product information, accessories, videos, photos and more. If you don't find the replacement part on our website, please contact Trikke Tech via e-mail at [tech@trikke.com](mailto:tech@trikke.com).



Trikke Tech, Inc.  
132 Easy Street - suite D1  
Buellton, California USA 93427  
Phone: 805-693-0800 fax: 805-693-0811

This manual and its contents are the property of Trikke Tech, Inc. No portion of the text or images in this manual can be reproduced without the prior written permission of Trikke Tech, Inc.  
Copyright © 2018 Trikke Tech, Inc.  
All Rights Reserved 2018



## WARNINGS



- READ AND UNDERSTAND THE ASSEMBLY MAINTENANCE AND SAFETY SECTIONS OF THE OWNER'S MANUAL BEFORE RIDING THE TRIKKE™ CAMBERING VEHICLE. ALWAYS FOLLOW THE INSTRUCTIONS AND PAY ATTENTION TO ALL WARNINGS.
- ALWAYS WEAR PROPER SAFETY EQUIPMENT WHEN RIDING THE TRIKKE CAMBERING VEHICLE, INCLUDING AN ANSI, SNELL, CPSC, ASTM, OR DIN EN 1078 APPROVED HELMET. WEAR PROPER FOOTWEAR AND SECURE LACES BEFORE RIDING.
- AVOID WATER, BUMPS, GRAVEL, SAND, CRACKS, UNEVEN SURFACES OR OBSTACLES THAT MAY STOP YOU SUDDENLY OR CAUSE YOU TO LOSE CONTROL. THE TRIKKE ELECTRIC VEHICLE IS NOT INTENDED FOR OFF-ROAD USE AND AVOID RIDING AT NIGHT.
- DO NOT LEAN HEAVILY ON THE HANDLEBARS. RIDER'S WEIGHT MUST BE MOSTLY ON IT'S FEET. EXCESSIVE WEIGHT ON THE HANDLEBAR IS UNSAFE AND CAN RESULT IN LOSS OF CONTROL AND POSSIBLE FALL, IF THE FRONT WHEEL NEEDS TO BE TURNED SHARPLY OR HITS AN OBSTACLE ON THE GROUND.
- USE BOTH HANDS TO HOLD THE HANDLEBARS FIRMLY AT ALL TIMES. ONE-HANDED OR HANDS FREE RIDING IS EXTREMELY DANGEROUS. DO NOT PUSH TOO HARD ON OR APPLY UNEVEN PRESSURE TO EITHER SIDE OF THE HANDLEBARS. DO NOT MAKE SUDDEN SHARP TURNS OR APPLY YOUR BODY WEIGHT TO THE HANDLEBARS WHEN TURNING. SUCH ACTIONS MAY CAUSE THE VEHICLE TO "JACK-KNIFE" OR TO STOP SUDDENLY WHICH CAN CAUSE SERIOUS INJURY TO THE RIDER.
- DO NOT LEAN BACK OR PULL BACK ON THE HANDLEBARS. DOING SO CAN CAUSE THE RIDER TO FALL OFF THE BACK OF THE VEHICLE POSSIBLY RESULTING IN SERIOUS INJURY OR EVEN DEATH. RIDER MUST KEEP ITS WEIGHT WITHIN THE AREA DELINEATED BY THE 3 WHEELS.
- DOWNHILL RIDING IS NOT RECOMMENDED, SPECIALLY FOR NOVICE RIDERS. THE TRIKKE ELECTRIC VEHICLE IS DESIGNED PRIMARILY FOR USE ON FLAT, DRY PAVEMENT. RIDING DOWN STEEP HILLS OR DOING PROLONGED DOWNHILL RIDES IS NOT RECOMMENDED. PROLONGED USE OF THE BRAKES CAN CAUSE THE BRAKES TO OVERHEAT AND DRAMATICALLY REDUCE THE REAR TIRES TO WEAR DOWN PREMATURELY, DRAMATICALLY REDUCING THE EFFECTIVENESS OF THE BRAKES OR EVEN CAUSING THEM TO FAIL. EXTREME CAUTION SHOULD ALWAYS BE USED WHEN RIDING ON ANY HILL.
- ALWAYS INSPECT THE VEHICLE BEFORE EACH RIDE AND MAKE SURE THAT THE HANDLEBAR, QUICK RELEASE AND FOLDING MECHANISMS ARE SECURELY LOCKED IN THE PROPER RIDING POSITION. READ THE ASSEMBLY SECTION OF THE OWNER'S MANUAL FOR IMPORTANT ASSEMBLY AND MAINTENANCE INFORMATION.
- TEST THE BRAKES FOR PROPER FUNCTION BEFORE EACH RIDE. ALWAYS APPLY BOTH BRAKES EVENLY WITH YOUR WEIGHT DISTRIBUTED EVENLY OVER EACH REAR WHEEL.
- CHILDREN SHOULD ALWAYS BE SUPERVISED BY AN ADULT WHEN RIDING. IT IS THE RESPONSIBILITY OF THE PARENT OR GUARDIAN TO PROPERLY MAINTAIN AND INSPECT THE VEHICLE BEFORE EACH RIDING SESSION BY A CHILD. THE Trikke EV CAMBERING VEHICLE IS NOT RECOMMENDED FOR CHILDREN UNDER 13 YEARS OF AGE.
- ALWAYS EXERCISE EXTREME CAUTION WHEN YOU ARE RIDING IN CLOSE PROXIMITY TO OTHER VEHICLES, PEDESTRIANS, AND ESPECIALLY TO CARS IF YOU ARE RIDING ON A STREET. BE SURE TO OBEY ALL RULES OF THE ROAD. PLEASE BE COURTEOUS TO OTHER RIDERS AND PEDESTRIANS WHO MAY BE SHARING THE PAVEMENT WITH YOU.
- DO NOT MODIFY YOUR Trikke EV VEHICLE. ONLY USE TRIKKE TECH, INC. APPROVED PARTS AND ACCESSORIES. SEE THE LIMITED WARRANTY FOR USE RESTRICTIONS.
- WE RECOMMEND THAT YOU NOT EXCEED THE RECOMMENDED RIDER WEIGHT RESTRICTION OF 250 LBS. OR 113 KG.