

Instant Hot Packs

Cardinal Health™ Instant Hot Packs help provide consistent heat therapy for convenient and effective pain relief. Our comprehensive portfolio includes a variety of different options and sizes, including standard and insulated products. They are made of non-toxic materials that do not contain DEHP.

#1
Instant Hot Pack
in hospitals¹



Features and benefits:

- Consistent and effective heat therapy
- Unique sodium thiosulfate heat technology
- Easy to activate — just squeeze and knead
- Can be applied directly to skin — no additional cover needed

Activation
is as easy as 1, 2, 3

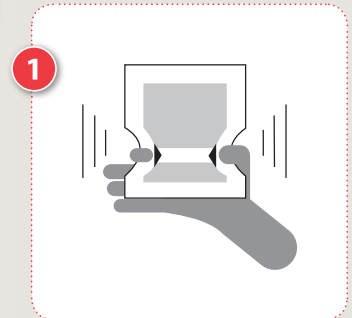

Squeeze sides firmly where indicated to activate

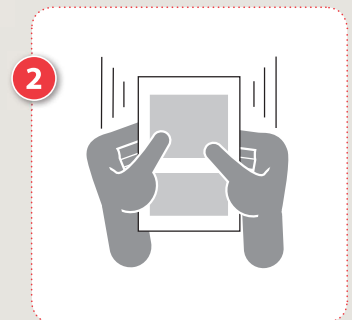

Knead pack well to mix contents



Apply to desired area for 30 minutes

Unique heat technology:

In order for heat therapy to be effective, the correct temperature range must be reached and sustained to provide the desired therapeutic effect. Most clinical authorities believe that the upper temperature limit that can be safely tolerated by the skin during the application of heat therapy is 109° to 111°F (43° to 44°C).² In order to be both safe and effective, heat therapy should consistently deliver the highest safe temperature that is possible without exceeding the tolerance level of the patient's skin.

Cardinal Health™ Instant Hot Packs use a unique sodium thiosulfate heat technology to quickly reach a safe therapeutic temperature of 110°F and maintain it consistently for 20-30 minutes. Unlike similar products on the market that utilize magnesium sulfate, Cardinal Health™ Instant Hot Packs do not spike to unsafe temperatures and can be applied directly to the skin without the use of an additional cover.

Average temperature during single heat therapy treatment³

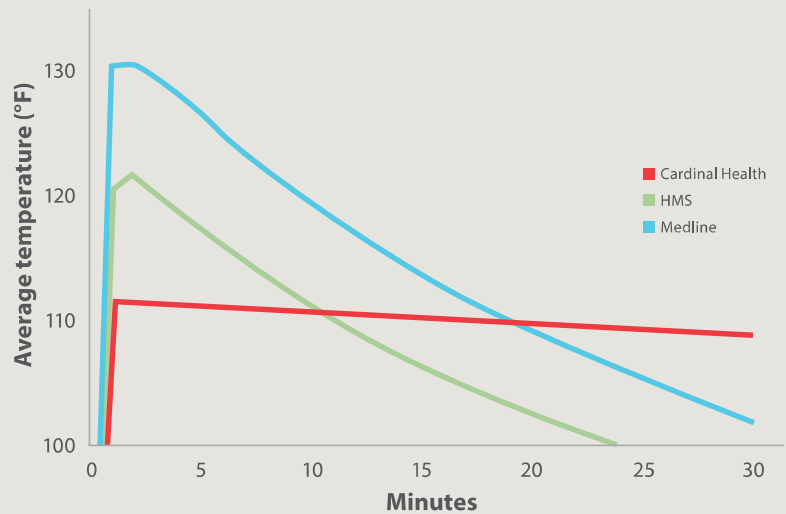

Chemical name	Cost of chemical	Hot pack manufacturing process	Temperature pattern produced
Sodium Thiosulfate	More expensive	More difficult	Consistent near 110°F
Magnesium Sulfate	Less expensive	Less difficult	Starts very hot, decreases quickly

Ordering information

Cat. No.	Description	Size (in.)	Packaging
11443-512	Instant Hot Pack, Small	4½ x 9 in.	6 ea/bx, 4 bx/cs, 24 ea/cs
11450-040	Instant Hot Pack, Medium	6 x 6½ in.	10 ea/bx, 4 bx/cs, 40 ea/cs
11443-012	Instant Hot Pack, Large	6 x 9 in.	4 ea/bx, 4 bx/cs, 16 ea/cs
30104	Instant Hot Pack, Insulated, Large	6 x 9 in.	24 ea/cs

Did you know?

Hospital acquired burns are considered a “Never” event. In October 2008, the Centers for Medicare & Medicaid Services (CMS) classified a burn acquired within a facility as a non-reimbursable secondary diagnosis.⁴