



285

Available in  
Black or White

## Rehab Shower/Commode Chair-Tilt

- Packages Now Available
- Stainless Steel Frame
- Several New Seat Options Available
- Tilt Adjustment
- Four Frame Sizes:  
16"wx18"D, 18"wx18"D, 20"wx18"D, and 22"wx18"D
- Seven Seat Sizes:  
16"wx18"D, 18"wx18"D, 18"wx20"D, 20"wx18"D, 20"wx20"D,  
22"wx18"D, and 22"wx20"D

The 285 is a gravity assist tilt-in-space shower/commode chair. Available in multiple frame widths from 16"-22" and the option of 4 casters or 24" rear wheels make this a versatile chair for the home or rehab environment.

Multiple features combine to provide support, comfort, and pressure relief along with the other benefits of tilt-in-space technology.



FRAMES



**P13635**  
16"Wx18"D  
Stainless Steel  
Frame



**P13636**  
18"Wx18"D  
Stainless Steel  
Frame



**P13637**  
20"Wx18"D  
Stainless Steel  
Frame



**P13638**  
22"Wx18"D  
Stainless Steel  
Frame



**60800-2**  
5" Dual Locking  
Casters  
(pair)



**P61096**  
24" Wheels  
(pair)



**P60549**  
24" Pneumatic  
Street Tread  
Wheels  
(pair)

AXLES

WHEEL LOCKS

FRONT CASTERS



**P61059**  
24" Flat Free Street  
Tread Wheels  
(pair)



**P61104**  
24" PVC Handrims  
(replaces standard  
handrims, pair)



**P13688**  
Bolted Axles with  
Tipping Levers  
(pair)



**P60532**  
Wheel Locks  
(pair)



**P13135**  
Wheel Locks with  
Extended Handle  
(pair)



**60841-2**  
5" Casters  
(pair)



**60800-2**  
5" Dual Locking  
Casters  
(pair)

SEATS



**P61124**  
16"Wx18"D  
Ensolite® 1" foam  
Front/Rear Open Seat  
A-4.75"xB-7.75" opening



**P60993**  
18"Wx18"D  
Comfortuff 1.5" waterfall foam  
Front/Rear Open Seat  
A-5"xB-8" opening



**P60974**  
18"Wx18"D  
Comfortuff sloped foam  
Front Open Seat  
A-4"xB-6.5" opening



**P60802**  
18"Wx18"D  
Ensolite® 1.25" foam  
Front Open Ring Seat  
A-4.5"xB-7.75" opening



**P61086**  
18"Wx18"D  
Ensolite® 2" foam  
Solid Seat



**P13771**  
18"Wx20"D  
Ensolite® 1" foam  
Front Open Seat  
A-4.5"xB-7.5" opening



**P61038**  
20"Wx18"D  
Comfortuff  
1.5" waterfall foam  
Front Open Seat  
A-5"xB-8" opening



**P60903**  
20"Wx18"D  
Ensolite® 1" foam  
Front/Rear Open Seat  
A-4.5"xB-7.75" opening



**PP61122**  
20"Wx18"D  
Ensolite® 1" foam  
Solid Seat



**P13772**  
20"Wx20"D  
Ensolite® 1.5" foam  
Race Track Oval Seat  
A-7.75"xB-12.75" opening



**P13773**  
20"Wx20"D  
Ensolite® 1" waterfall foam  
Front/Rear Open Seat  
A-4.5"xB-7.75" opening



**P60905**  
22"Wx18"D  
Ensolite® 1" foam  
Front/Rear Open Seat  
A-4.5"xB-7.75" opening



**P13774**  
22"Wx20"D  
Ensolite® 1.5" foam  
Race Track Oval Seat  
A-7.75"xB-12.75" opening



**P13775**  
22"Wx20"D  
Ensolite® 1" waterfall foam  
Front/Rear Open Seat  
A-4.5"xB-7.75" opening

ARMRESTS



**P13611**  
Left Hand Armrest  
with Pad



**P13612**  
Right Hand Armrest  
with Pad



**P13613**  
Left Hand Armrest  
with Arm Trough



**P13614**  
Right Hand Armrest  
with Arm Trough



**P13615**  
Left Hand  
Height-Adjustable  
Armrest



**P13616**  
Right Hand  
Height-Adjustable  
Armrest

LEG RESTS

FOOT PLATES



**PL13581**  
Left Gooseneck  
Leg Rest



**PR13581**  
Right Gooseneck  
Leg Rest



**P13582**  
Left Elevating  
Leg Rest



**P13583**  
Right Elevating  
Leg Rest



**PL11099**  
Left Foot Plate



**PR11099**  
Right Foot Plate



**PL11100**  
Left Foot Plate with  
Heel Loop

FOOT PLATES



**PR11100**  
Right Foot Plate  
with Heel Loop



**P61137**  
Left Oversized  
Aluminum  
Foot Plate



**P61138**  
Right Oversized  
Aluminum  
Foot Plate



**PL11101**  
Left Padded  
Foot Plate



**PR11101**  
Right Padded  
Foot Plate



**P61139**  
16"W Adjustable  
Sling Back



**P11106**  
16"W Solid Back  
Full Length w/  
Center Pad

BACKS



**P11110**  
16"W Solid Back



**P60877**  
18"W Adjustable  
Sling Back



**P11107**  
18"W Solid Back



**P60878**  
20"W Adjustable  
Sling Back



**P11108**  
20"W Solid Back



**P61140**  
22"W Adjustable  
Sling Back



**P11109**  
22"W Solid Back

BELTS



**PW60884**  
Waist Belt  
(48" circumference with  
12" velcro overlap)



**PT60910**  
Trunk Belt  
(48" circumference with  
12" velcro overlap)



**P60879**  
Calf Strap



**P11093**  
Bodypoint®  
Trunk Belt



**P11102**  
Bodypoint®  
Trunk Belt (pair)



**P11116**  
Bodypoint® Trunk  
Belt & Waist Belt



**P11112**  
Bodypoint® XL  
Trunk Belt

POSITIONING AIDS



**P11113**  
Belt w/Quick  
Release Knobs



**P61081**  
Bodypoint®  
Calf Strap



**P11114**  
Bodypoint®  
Knee Belt



**PL13574**  
Left Hand  
Swing-Away  
Adjustable Lateral



**PR13574**  
Right Hand  
Swing-Away  
Adjustable Lateral



**PL13618**  
Left Hand  
Arm-Mounted  
Hip Guide



**PR13618**  
Right Hand  
Arm-Mounted  
Hip Guide

PANS



**P61006**  
Abductor/Deflector  
Small



**P13224**  
Pan/Hanger for  
Ring and  
Contoured Seats



**P13423**  
Pan/Hanger for  
Front/Rear, & Race  
Track Oval Seats



**P11105**  
Head Support  
Small Foam  
(only available for  
P11104)



**P13621**  
Head Support  
Large

HEAD SUPPORTS

Front Open Seat  
Opening Measurements

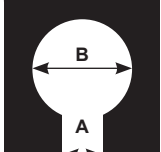

Race Track Oval  
Opening Measurements

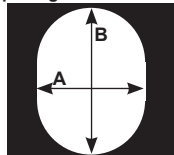

full option details at  
[activeaid.com](http://activeaid.com)



285 with Support Options



PKG207 Package #5 - 18"W x 18"D

## SPECIFICATIONS

Weight Capacity	350 lbs.
Maximum Tilt	30°
Top of Seat to Top of Back	22"
Floor to Top of Seat	25"
Seat Width	16", 18", 20" and 22"
Seat Depth	18" and 20"
Floor to Bottom of Seat Frame (without pan)	19.75"
Width Between Arm Pads	20.25"
Top of Seat to Top of Armrest Pads	7.5"
Overall Width	24.5"
Maximum Back Slack	3.5"
Headrest Height from Seat to Bottom of Cervical Support	20.25" - 28.25"
Minimum Overall length with Footrest – No Tilt	47"
Maximum Overall Length with Footrest – Full Tilt – Headrest in	61"
Legrest Range	15.5"-21.5"
Under Seat Width Clearance	17.5"