

# 202



## New White Frame!

### Rehab Shower/Commode Chair-Bath/Toilet Modular System

- Packages Now Available
- Stainless Steel Frame
- Height Adjustable
- Can be used as a Raised Toilet Seat or Bath Transfer Bench
- Lightweight
- 350 lb. Weight Capacity
- Several New Seat Options Available

The 202 is unique in its design to accommodate perineal access from any of four directions. The cut-out portion of the seat can be placed over the toilet in the desired direction and the legs can be adjusted in height while maintaining a stable platform for seating.

With the 5 different seating options and large seating surface the 202 provides excellent support while the cut-out may offer some additional pressure relief. With these options, the customer can find the size, contour, and shape to fit a wide range of needs. It is lightweight, easy to move out of the way, and no tools are required for disassembling the legs for travel or for other adjustments. Easy to use, versatile, sturdy, and comfortable makes the 202 an outstanding bathroom aid.



## FRAMES



**P13641**  
18"Wx18"D  
White Stainless  
Steel Frame

## LEGS



**P13642**  
Legs  
w/Crutch Tips  
(height seat range  
from floor to bottom  
frame-19.5"-22.5")



**P13643**  
Legs  
w/Suction Tips  
(height seat range  
from floor to bottom  
frame-19.5"-22.5")

\*Seat works in all 4 positions

## SEATS



**P60993\***  
18"Wx18"D  
Comfortuff 1.5" waterfall foam  
Front/Rear Open Seat  
A-5"xB-8" opening



**P60913\***  
18"Wx18"D  
Ensolite® 2" waterfall foam  
Front/Rear Open Seat  
A-5.25"xB-8" opening



**P61086\***  
18"Wx18"D  
Ensolite® 2" foam  
Solid Seat



**P61058**  
18"Wx18"D  
Ensolite® 2" waterfall foam  
Front Open Contoured Seat  
A-5.5"xB-8.25" opening



**P60850\***  
18"Wx18"D  
Ensolite® 1" waterfall foam  
Front/Rear Open Seat  
A-5"xB-8" opening

## BACKS



**P13295**  
Back Tubes w/Solid  
Back Pad  
(13.5"H)



**PL13291**  
Left Hand  
Armrest with Pad



**PR13291**  
Right Hand  
Armrest with Pad



**PW60908**  
Waist Belt  
(48" circumference with  
12" velcro overlap)



**PT60908**  
Trunk Belt  
(48" circumference with  
12" velcro overlap)

## BENCHES



**P13294**  
B-O Transfer Bench



**P13352**  
Short Transfer  
Bench



**P13644**  
18"Wx18"D  
Pan/Hanger

## PANS

full option details at  
[activeaid.com](http://activeaid.com)

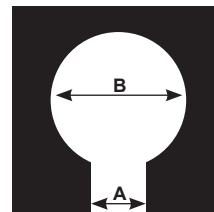
Seat Opening  
Measurements

## SPECIFICATIONS

Weight Capacity	350 lbs.
Height Adjustment Range from Floor to Bottom of Frame	20"-23"
Frame Dimensions	18"W x 18"D
Back Height from Seat	14"
Height of Arms from Seat	8"