

## Double Electric Breast Pump

**EN** Instructions for use



## Congratulations on joining the Ameda family!

We are excited to help you meet your breastfeeding goals along your breastfeeding journey with your baby. With our Ameda breast pump and HygieniKit® Milk Collection System, you can express and collect your breast milk safely and effectively.













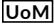
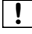

The Ameda HygieniKit is a closed system that contains a diaphragm that keeps the air from the pump and tubing separate from the pump parts that are exposed to your breast milk, so your tubing stays dry. This diaphragm helps prevent milk backup into tubing.

If you have any questions regarding your Ameda breast pump or HygieniKit, we have a certified customer service ParentCare team available to help you. Have your breast pump and parts nearby when you call. ParentCare is available by phone during business hours on weekdays at **1.866.992.6332**. Please check [www.ameda.com](http://www.ameda.com) for up-to-date available times.

For more information about breastfeeding, breast pumping or Ameda products visit [www.ameda.com](http://www.ameda.com). For more product information or feedback in other countries, visit [www.ameda.com](http://www.ameda.com) for a list of distributors outside of the United States.

1.	WARNINGS & CAUTIONS .....	4
2.	INTENDED USE .....	6
3.	CONTRADICTIONS FOR USE .....	6
4.	PRODUCT DESCRIPTION .....	7
5.	SET-UP INSTRUCTIONS .....	8
	5.1 Before First Use: Cleaning The HygieniKit .....	8
	5.2 Assembling the HygieniKit Milk Collection System .....	9
6.	INSPECTING BEFORE PUMPING .....	11
7.	OPERATING INSTRUCTIONS .....	11
	7.1 Plug into Power Source .....	11
	7.2 Button Control .....	12
	7.3 LCD Icons & Modes .....	12
	7.4 To Begin Pumping .....	13
	7.5 How to Fit Your Flange .....	15
	7.6 Breast Milk Storage Guidelines .....	15
8.	CLEANING THE HYGIENIKIT .....	16
9.	MAINTENANCE .....	17
	9.1 Breast Pump Valve Check .....	17
	9.2 Storing & Transporting .....	17
10.	TROUBLESHOOTING .....	17
11.	WARRANTY .....	19
12.	TECHNICAL DATA .....	20
	12.1 Specifications .....	20
	12.2 Electromagnetic Compatibility .....	21
	12.3 Product Disposal .....	23
13.	OPERATIONAL & STORAGE CONDITIONS .....	23
14.	TRAVEL OR INTERNATIONAL USE .....	24
15.	AMEDA ACCESSORIES & SPARE PARTS .....	24

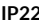
### Icon Glossary

	Warning		Protect from sunlight		Manufacturer
	Caution		Keep Dry		Unit of Measure
	Important		Temperature Range		Class II/Double Insulated
	Washing Instruction		Humidity Range		Type BF Applied Part
	Yes		Defines the atmospheric pressure range		Solid Particle/Liquid Ingress Classification
	Fragile				Waste Electrical and Electronic Equipment

# 1. WARNINGS & CAUTIONS

## IMPORTANT SAFEGUARDS



When using electrical products, especially if children are present, the following basic safety precautions should always be followed.

## READ ALL INSTRUCTIONS BEFORE USING THIS PRODUCT

**DANGER:** To reduce the risk of electrocution:

- Always unplug electrical product immediately after use.
- **DO NOT** use while bathing, showering or swimming.
- **DO NOT** place or store where product can fall or be pulled into a bathtub, shower, sink, or pool.
- **DO NOT** place or drop product into water or other liquid.
- **DO NOT** reach for electrical product that has fallen into water. Immediately unplug from electrical outlet.

The **WARNING** symbol identifies important safety instructions that if not followed can lead to injury or damage to the breast pump. The warning symbols when used with the following words stand for:

	<b>WARNING</b> Can lead to serious injury or death.
	<b>CAUTION</b> Can lead to minor injury.
	<b>IMPORTANT</b> Can lead to material damage.



**WARNING:** To avoid fire, electrocution, serious burns or injury:

- **NEVER** leave product unattended when plugged into an electrical outlet.
- Close supervision is necessary when product is used near children or persons with disabilities.
- Use product for its intended use **ONLY**, as described in this manual.
- **DO NOT** use parts that are not recommended by the manufacturer.
- Prior to use, always inspect power adapter for damage or exposed wires. If damage and/or exposed wires are found, do not use power adapter and call Ameda Customer Service ParentCare at **1.866.992.6332**.
- **NEVER** operate electrical product: if it has a damaged cord or plug; if it is not working properly; if it has been dropped, damaged, or becomes wet.
- Keep cord away from heated surface.
- **DO NOT** install batteries backwards, charge, put in fire, or mix with other battery types. May explode or leak causing injury. Replace all batteries at the same time.
- **NEVER** use while sleeping or when drowsy.
- **NEVER** insert or drop any object into any opening or into tubing.

### *Environmental Conditions That Affect Use*

- **DO NOT** use outdoors with electrical cord.
- **DO NOT** operate where oxygen or aerosol spray products are being used.



## **WARNING:** To avoid health risk and reduce the risk of injury:

This product is a personal care item and intended for use by only one user. This product should not be shared between users or resold or given from one user to another. Pumping does not prevent transmission of substances or infections carried via breast milk to baby.

*Note: Do not use product if damaged. Use product only for intended use as described in this manual.*

- **DO NOT** use pump while driving.
- Pumping can induce labor, **DO NOT** use while pregnant unless approved by your breastfeeding specialist or healthcare professional.
- Prior to first use and after every use, clean all parts (flange, diaphragm, valve and bottle) that come in contact with your breast and breastmilk.
- **DO NOT** use attachments other than those recommended by manufacturer
- **DO NOT** make mechanical or electrical modifications to breast pump base.
- Inspect all appropriate pump components before each use. Check the parts for cracks, chips, tears or wear. **DO NOT** use, contact Ameda Customer Service ParentCare at **1.866.992.6332** immediately.
- **DO NOT** continue pumping for more than 2 consecutive pumping sessions if no results are achieved.
- **DO NOT** heat or thaw frozen breastmilk in a microwave or boiling water. Microwaving can heat liquids unevenly. Both microwaving and boiling water can result in possible burns.
- If you are a mother who is infected with Hepatitis B, Hepatitis C or Human Immunodeficiency Virus (HIV), pumping breast milk will not reduce or remove the risk of transmitting the virus to your baby through your breast milk.
- If irritation or discomfort occurs, discontinue use and see a doctor.
- Accessible materials may cause allergic reactions.

**STRANGULATION HAZARD:** Keep tubing and cords out of reach of children.

**CHOKING HAZARD:** Small parts, **NOT** for children under 3 years.



## **CAUTION:** Can lead to minor injury:

- If batteries are in pump base, remove batteries before using the power adapter.
- **DO NOT** wrap cord around the body of the adapter.
- Use **ONLY** the AC power adapter that is recommended for the Ameda Mya Joy Breast Pump.
- **DO NOT** shorten tubing or modify the breast pump kit.
- Make sure the voltage of the power adapter is compatible with the power source.
- Plug the AC power adapter into the pump base prior to plugging into the wall socket.
- Remove AC power adapter from power source and remove batteries before wiping outside of pump base clean with a damp cloth.
- Keep away from dust, lint and direct sunlight, as damage may occur to breast pump where speed and suction may be reduced.
- **DO NOT** attempt to remove the breast flange from your breast while pumping. Turn the breast pump off and with your finger, break the seal between your breast and breast flange, then remove breast flange from your breast.
- **ALWAYS** place pump on a horizontal flat surface when using product.
- **DO NOT** change batteries or open battery cover when pump is on.
- Remove batteries before storing product for long periods of time.



**IMPORTANT:** Can lead to material damage.

- **NEVER** put electrical product in water or a sterilizer, as you can cause permanent damage to the breast pump.
- **DO NOT** use antibacterial or abrasive cleaners/detergents when cleaning breast pump or breast pump parts.
- When plastic bottles and plastic breast pump kit parts are frozen, they can become brittle and may break when dropped.
- **DO NOT** over-fill bottles. Replace bottles before they overflow.
- Bottles and breast pump kit parts may become damaged if mishandled, e.g. dropped, overtightened, or knocked over.
- Always check bottles or breast pump kit parts prior to pumping. Discard breastmilk if bottles or breast pump kit parts are damaged.



**SAVE THESE INSTRUCTIONS**

## 2. INTENDED USE

The Ameda Mya Joy Breast Pump is intended to express and collect the mother's milk from the breasts of a nursing woman for the purpose of feeding the collected milk to a baby.

## 3. CONTRADICTIONS FOR USE

There are no known contradictions for use with this product.

## 4. PRODUCT DESCRIPTION

### Ameda Mya Joy & HygieniKit Milk Collection System

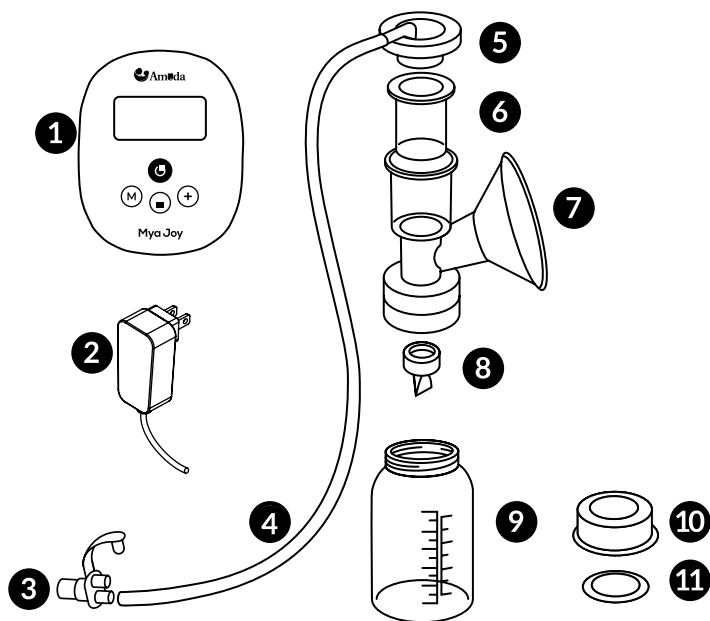

### Contents

1. Ameda Joy Pump Unit

2. Power Adapter

Ameda HygieniKit Milk Collection System

3. Tubing Adapter

4. Tubing

5. Adapter Cap

6. Diaphragm

7. Breast Flange (25.0mm)

8. Silicone Valve

9. Bottle

10. Bottle Locking Ring Cap

11. Bottle Locking Disc

*Pump parts may vary*

## 5. SET-UP INSTRUCTIONS

### 5.1 Before First Use: Cleaning The HygieniKit

Sanitizing is important for hygiene and serves to kill living organisms, such as bacteria or viruses.

Refer to the cleaning and disinfection section for the continued cleaning of your device. Before first use, unless otherwise directed by your healthcare provider, prepare the product for use as follows:

1. Disassemble all parts & clean using breast pump cleaning instructions. See the Center for Disease Control website - <https://www.cdc.gov/healthywater/hygiene/healthychildcare/infantfeeding/breastpump.html> for additional cleaning guidelines.
2. **POP OFF** the adapter cap from the flange and refer to the page 8 product description for the illustration.
3. **SET ASIDE** adapter cap, tubing and tubing adapter— you do not need to take these apart from each other. These 3 parts **DO NOT** need to be washed before first use or after each use — milk does not come into direct contact with these parts.

**NOTE:** Inspect the tubing. If you find condensation in the air tube, wash and dry it immediately or replace the tubing. If you see breast milk inside the tubing or tubing connector do not attempt to wash, clean or sterilize the tubing or tubing connector. Instead contact Ameda, Inc.

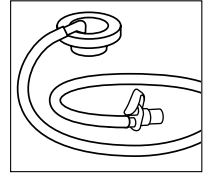

**DO NOT** wash adapter cap, tubing and tubing adapter.

Take apart the remaining parts, the diaphragm, flange, valve and milk storage bottles, including locking ring and locking disc, since these are the parts that can touch the breast milk once you begin pumping.



**WASH HANDS THOROUGHLY** with soap and water before touching breast pump, kit and breasts.



**SANITIZE by Boiling**

**DO NOT** allow boiling parts to contact bottom of pot. It may cause damage to parts.



**WARNING: DO NOT** leave boiling parts unattended. Remove parts carefully from boiling water to avoid burning. Boiled water and steam from boiled water can cause severe skin burns, so use caution when boiling parts in water and removing parts from boiling water.

**ALTERNATIVE TO BOILING:**



**SANITIZE in Microwave:** Follow steam bag manufacturers' instructions.

**IMPORTANT:** Set aside tubing, adapter cap and tubing adapter. These parts **DO NOT** need to be washed.

- Please check pump kit parts for cracks, chips, tears or deformation before and after sanitization process.

Use only microwave bags specifically labeled for disinfecting breast pump components and refer to the microwave bag labeling for further instructions.



**WARNING:** Please use precaution. The major risk with steam bags is scalding so moms and caregivers should be very careful when they take the bag out of the microwave.

**CLEAN TUBING:** It is necessary to wash the tubing only if condensation is present. If condensation is present in the tube, wash and dry it immediately or replace the tubing. If milk is present in the tubing, do not attempt to wash or clean the tubing. Instead contact Ameda Customer Service at 1.866.992.6332.

**HOW TO WASH TUBING:**

1. Rinse the tubing by pouring cool water and make sure the water flows through the entire tubing from one end to the other end.
2. Wash the tubing in warm, soapy water and rinse thoroughly.

**HOW TO DRY TUBING:**

Hang the tubing to air dry and make sure that the tubing is completely dry before using.



## 5.2 Assembling the HygieniKit® Milk Collection System

Once your pump parts are completely dry before use, wash your hands thoroughly and assemble the HygieniKit® Milk Collection System (Pump Kit).

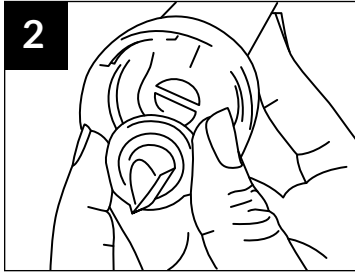
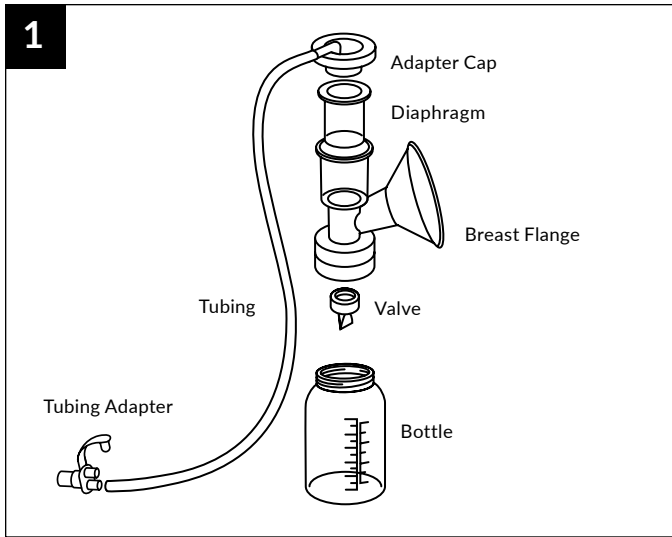

**HOLD** by the rim or thicker sides of the valve.

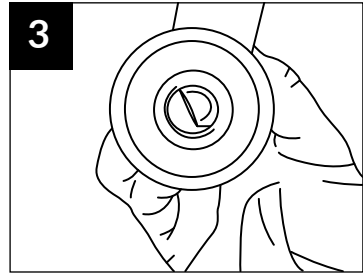

**PUSH** the valve onto the bottom of the flange.

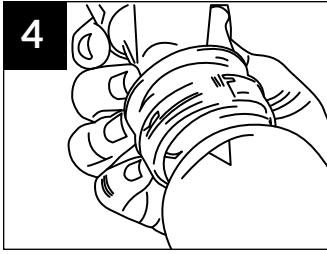

**ATTACH** and **TIGHTEN** the bottle or attach milk storage bag.

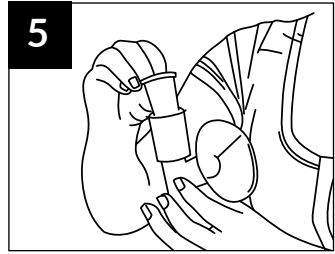

**INSERT** the diaphragm into the top of the flange.

*It is important that the inside of the diaphragm is completely DRY to avoid moisture from forming in the tubing.*

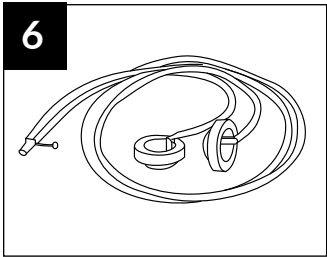

**ATTACH** the adapter cap(s) by pressing it onto the top of the flange(s) until you hear a pop.

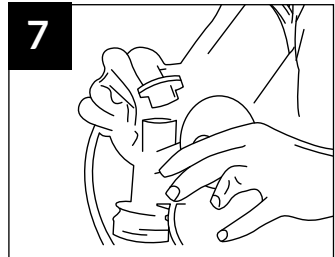

The tubing should still be **CONNECTED** to the adapter cap(s) and tubing adapter.

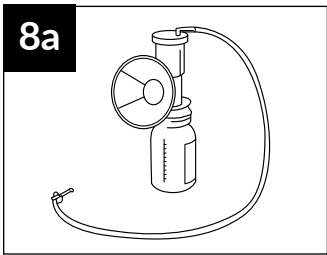

**ASSEMBLED HYGIENIKIT**  
for single pumping.

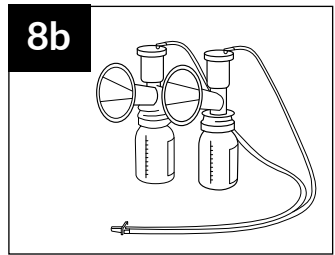

**ASSEMBLED HYGIENIKIT**  
for double pumping.

Pump parts may vary.

## 6. INSPECTING BEFORE PUMPING



**IMPORTANT:** Before using the Ameda Mya Joy and HygieneKit system, check the parts for cracks, chips, tears, or wear. They can affect the function of the kit. If parts need replacing due to defects, please call your local distributor or the location where you purchased the pump. Do not use damaged parts. For a listing of distributors in your country, please visit [www.ameda.com](http://www.ameda.com).

## 7. OPERATING INSTRUCTIONS

### 7.1 Plug into Power Source

*Choosing and checking your electrical source*

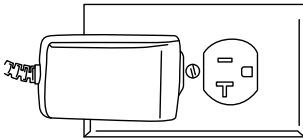

#### AC POWER ADAPTER



**WARNING:** Use only the AC power adapter recommended for the Ameda Mya Joy. AC power adapters with Australia, United Kingdom or Europe or other international plug configurations are not intended for use in the USA or Canada.



**WARNING:** Always inspect the AC power adapter for damage such as kinking or twisting of cords or frayed or exposed wires. If damaged, discontinue use immediately and call customer service at 1.866.992.6332.

1. If batteries are in pump base, **REMOVE** batteries before using AC power adapter plug.
2. **PUSH** small end of AC power adapter into left side of the pump base as shown.
3. **PLUG** other end into AC outlet.

#### BATTERIES



**WARNING: DO NOT** install backwards, charge, put in fire, or mix with other battery types. May explode or leak causing injury. Replace all batteries at the same time.

1. **OPEN** battery compartment on the bottom of the pump base.
2. **INSERT** four new AA batteries as shown.
3. **CLOSE** the battery compartment.

#### Low Battery Notification

When batteries are low, the LCD screen will display "Lo" notification. You may then replace all batteries or use the AC Power Adapter.

**TIP: USE** new premium batteries (such as Energizer, Duracell), insert correctly as shown.

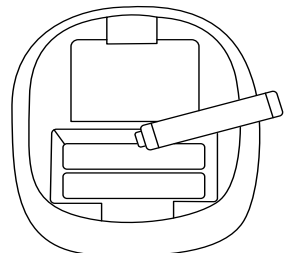

## 7.2 Button Control

### A. POWER ON/OFF BUTTON

### B. MODE SELECTION BUTTON

Switches between Stimulation Mode and Expression Mode

### C. - / + VACUUM LEVEL

Decreases or increases suction strength during pumping

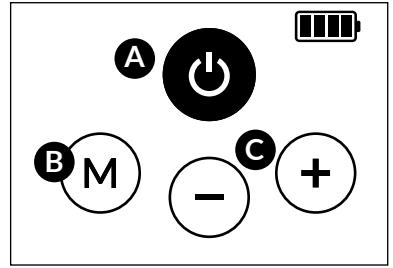

## 7.3 LCD Icons & Modes

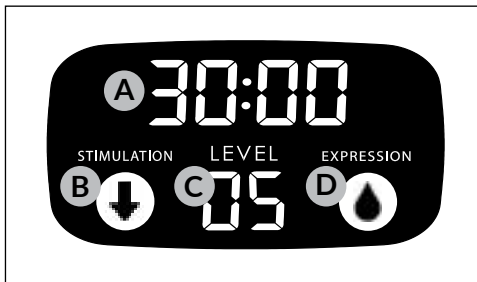

### A. TIMER DISPLAY

Tracks pumping time. Automatically shuts-off after 45 minutes.

### B. STIMULATION MODE



Mimics baby's fast suction pattern with fast speed and low suction to start milk flowing. This icon will disappear when in Expression Mode.

**NOTE:** After two minutes, the pump will automatically switch to Expression Mode unless you manually adjust prior.

### C. SUCTION STRENGTH LEVEL

Level of suction strength during pumping. The Ameda Mya Joy has 2-phase adjustable suction modes:

- Stimulation Mode: 1 - 6 levels
- Expression Mode: 1 - 12 levels

Adjust the suction level by pressing the  or  button to decrease and increase levels.

### D. EXPRESSION MODE

Mimics baby's slow, steady suction pattern with slower speed and higher suction to express more milk gently and efficiently. This icon will disappear when in Stimulation Mode.

## 7.4 To Begin Pumping

### STEP 1: CONNECT THE POWER ADAPTER

Insert the power adapter into LEFT side of pump base.

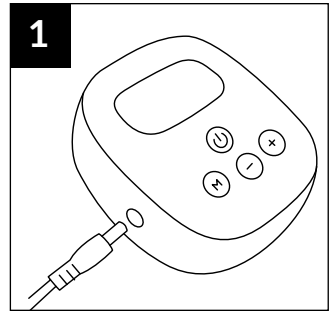

### STEP 2: INSERT TUBING

Insert the tubing into the adapter into RIGHT side of pump base, then turn slightly to the right while pushing in firmly.

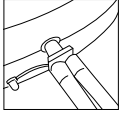

A. For **DOUBLE PUMPING**: Both tubes should be attached to the tubing adapter.

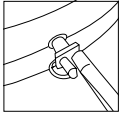

B. For **SINGLE PUMPING**: Remove one tube from the tubing adapter and close one side.

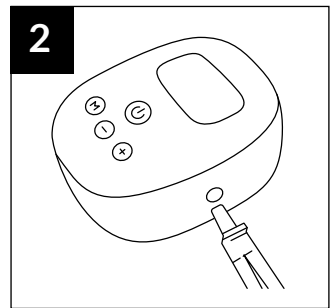

### STEP 3: PLACE THE FLANGE ON BREAST

Center flange on breast to create seal.

Check breast flange fit, if pumping causes discomfort a larger or smaller breast flange size may be needed. See section on how to properly fit your flange.

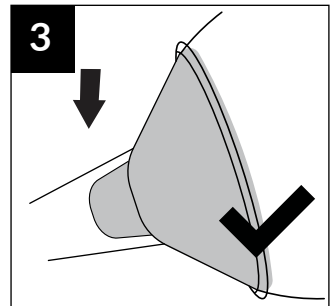

### STEP 4: POWER ON THE PUMP

Press the Power button to turn on the device. It will begin in Stimulation Mode.

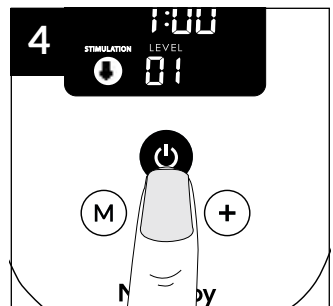

### STEP 5: ADJUST VACUUM LEVEL

Adjust the Stimulation Vacuum Level between 1 and 6 to your preferred comfort level. Never set to uncomfortable level.

*TIP: Start off with the suction low, and then gradually increase the suction setting to your comfort level. You may find that the level of suction that you are comfortable with varies from day to day, during the day and even during the same expression session.*

**NOTE:** After two minutes, the pump will automatically switch to Expression Mode unless you manually adjust prior.

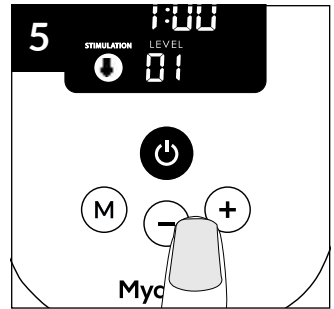

### STEP 6: CHANGE MODE

Once your milk starts to flow, press the Mode button to switch into Expression Mode.

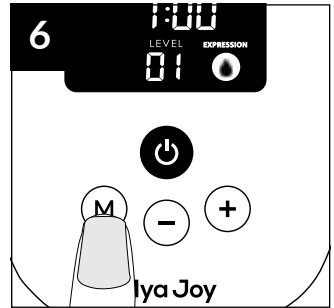

### STEP 7: ADJUST VACUUM LEVEL

Adjust the Expression Vacuum Level between 1 and 12 to your preferred comfort level. Never set to uncomfortable level.

*TIP: Start off with the suction low, and then gradually increase the suction setting to your comfort level. You may find that the level of suction that you are comfortable with varies from day to day, during the day and even during the same expression session.*

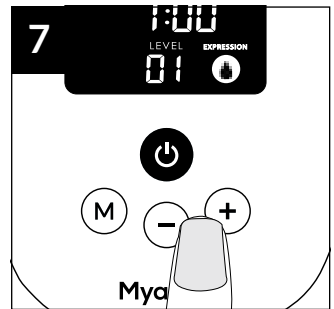

### STEP 8: END PUMPING SESSION

When you wish to stop expressing, first press the Power button, then remove milk collection kit from your breast.

*TIP: After pump is off, if necessary, INSERT a finger between breast and breast flange to break suction.*

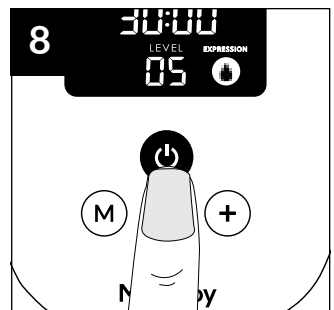

## 7.5 How to Fit Your Flange

Check breast flange fit, if pumping causes discomfort a larger or smaller breast flange size may be needed.

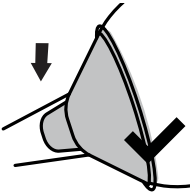

### GOOD FIT

During pumping, your nipple moves freely in the breast flange tunnel. You see space around the nipple. Not much areola is drawn into the tunnel with the nipple.

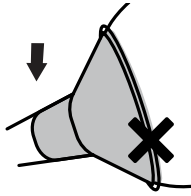

### FLANGE TOO SMALL

During pumping, some or all of your nipple rubs against the sides of the breast flange tunnel.

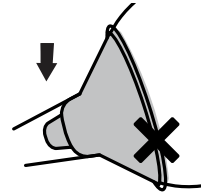

### FLANGE TOO LARGE

During pumping, more areola is drawn into the breast flange with your nipple. Your areola may rub against the side of the breast flange tunnel.

## 7.6 Breast Milk Storage Guidelines

- 1: Write the date on the storage container. Include your child's name if you are giving the milk to a child care provider.
- 2: Gently swirl the container to mix the cream part of the breastmilk that may rise to the top back into the rest of the milk. Do not shake the milk. This can make some of the milk's valuable parts break down.
- 3: Refrigerate or chill milk right after it is pumped, if possible. You can put it in the refrigerator, place it in a cooler or insulated cooler pack, or freeze it in small (2- to 4-ounce) batches for later feedings. Pumped milk is OK without being refrigerated for up to 4 hours after pumping.

	Room Temperature 77°F (25°C)	Time in Refrigerator 39°F (4°C)	Time in Freezer 0°F (-18°C)
Fresh Expressed or Pumped	Up to <b>4 hours</b>	Up to <b>4 days</b>	<b>6 Months</b> - Best <b>12 Months</b> - Acceptable
*Thawed, Previously Frozen	<b>1-2 Hours</b>	Up to <b>1 day</b> (24 hours)	<b>Do Not</b> Refreeze
Leftover from Feeding (baby did not finish bottle)	Use within <b>2 hours</b> after the baby is finished feeding		

**\*NOTE:** When thawing frozen milk, label as thawed when completely thawed (i.e. no ice crystals present). Use the time when completely thawed to base acceptable time limits for use rather than when it is taken from the freezer. These guidelines for storage and thawing of breast milk are a recommendation. Contact your lactation consultant or breastfeeding specialist for further information.

These guidelines are for healthy full-term babies and may vary for premature or sick babies. Check with your health care provider. Find more breastfeeding resources at: [WICBreastfeeding.fns.usda.gov](http://WICBreastfeeding.fns.usda.gov) and [www.cdc.gov/breastfeeding/](http://www.cdc.gov/breastfeeding/)

## 8. CLEANING THE HYGIENIKIT®

### BEFORE EVERY USE



Wash hands with soap and water. **Inspect and assemble** clean pump kit. If your tubing is moldy, discard and replace immediately.

Clean pump dials, power switch, and countertop with disinfectant wipes, especially if using a shared pump.

### AFTER EVERY USE

**Store milk safely.** Cap milk collection bottle or seal milk collection bag, label with date and time, and immediately place in a refrigerator, freezer, or cooler bag with ice packs.

**Clean pumping area,** especially if using a shared pump. Clean the dials, power switch, and countertop with disinfectant wipes.

**Take apart** breast pump tubing and separate all parts that come in contact with breast/breast milk.

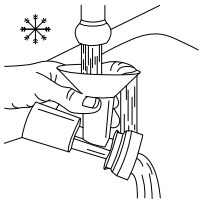

**Rinse** breast pump parts that come into contact with breast/breast milk by holding under running water to remove remaining milk.

Do not place parts in sink to rinse.

**Clean pump parts** that come into contact with breast/breast milk as soon as possible after pumping.

You can clean your pump parts in a dishwasher or **by hand** in a wash basin used only for cleaning the pump kit and infant feeding items.

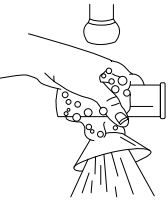

**Place pump parts** in a clean wash basin used only for infant feeding items. **Do not place pump parts directly in the sink!**

**Add soap and hot water** to basin.

**Scrub** items using a clean brush used only for infant feeding items.

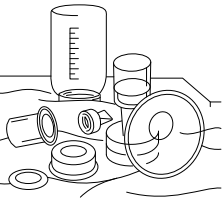

**Rinse** by holding items under running water, or by submerging in fresh water in a separate basin.

**Air-dry thoroughly.** Place pump parts, wash basin, and bottle brush on a clean, unused dish towel or paper towel in an area protected from dirt and dust. Do not use a dish towel to rub or pat items dry!

**Clean wash basin and bottle brush.** Rinse them well and allow them to air-dry after each use. Wash them by hand or in a dishwasher at least every few days.

For detailed instructions on sanitizing your pump parts, visit <https://www.cdc.gov/healthywater/hygiene/healthychildcare/infantfeeding.html>



**IMPORTANT:** The flanges and milk storage containers can also be washed on upper rack of a standard, household dishwasher. **DO NOT** use solvents or abrasives. Allow to air dry on a clean surface.

**Cleaning the pump:** Turn the breast pump off. Unplug the pump from the power source; wipe the pump with a clean, damp cloth and dry with a clean towel.



## 9. MAINTENANCE

The breast pump base does not require service or maintenance except for changing batteries, if applies.

### 9.1 Breast Pump Valve and Diaphragm Check



Inspect the valves and diaphragms for tears or holes. Replace any damaged valves and diaphragms prior to pumping. Wash valves and diaphragms per cleaning section. Do not insert bottle brush or something similar into valves. We recommend replacing valves and diaphragms approximately every 8-12 weeks but this can vary depending on cleaning and use.

### 9.2 Storing & Transporting

Disconnect HygieniKit and power adapter from pump before transporting or storing the product. When storing product, store in conditions as described in these instructions. Remove batteries before storing product for long periods of time. Handle with care when transporting product.

## 10. TROUBLESHOOTING

### SLOW MILK FLOW, UNEVEN OR NO SUCTION

#### VALVE AND DIAPHRAGM CHECK

Inspect the valves and diaphragms for tears or holes.

Replace any damaged valves and diaphragms prior to pumping. Wash valves and diaphragms per cleaning section. Do not insert bottle brush or similar into valves. We recommend replacing valves and diaphragms approximately every 8-12 weeks but this can vary depending on cleaning and use.

#### CONNECTION CHECK

Check assembly is correct and connection points are securely attached.

- Tubing adapter to tubing port
- Tubing adapter to tubing

Check adapter cap is attached to breast flange. It may be useful to remove adapter cap and reattach to breast flange.

#### FLANGE/BOTTLE CHECK

Check flanges, adapter cap or bottles for chips, cracks, breaks, or other damage. Replace any damaged flanges/adapter caps/bottles prior to pumping.

#### BREAST FLANGE FIT CHECK

- Good Fit: Nipple is moving freely in tunnel of flange
- Too Small: Nipple is rubbing against tunnel of flange
- Too Large: Areola is being pulled into tunnel of flange
- Check to make sure the breast shields form a complete seal around the breast while pumping

<p><b>AUDIBLE, HISSING NOISE OR AIR LEAKAGE</b></p>	<p><b>VALVE AND DIAPHRAGM CHECK</b></p> <p>Inspect the valves and diaphragms for tears or holes. Replace any damaged valves and diaphragms prior to pumping. Wash valves and diaphragms per cleaning section. Do not insert bottle brush or similar into valves. We recommend replacing valves and diaphragms approximately every 8-12 weeks but this can vary depending on cleaning and use.</p> <p><b>CONNECTION CHECK</b></p> <p>Check assembly is correct and connection points are securely attached.</p> <ul style="list-style-type: none"> <li>• Tubing adapter to tubing port</li> <li>• Tubing adapter to tubing</li> </ul> <p>Check adapter cap is attached to breast flange. It may be useful to remove adapter cap and reattach to breast flange.</p>
<p><b>POWER SOURCE</b></p>	<p><b>AC POWER ADAPTER</b></p> <p>Ameda Mya Joy is optimized for use with the AC Power Adapter. Make sure the AC power adapter is plugged all the way into the side of your pump base. Make sure there are no batteries installed in the pump base. Make sure you rotate the suction dial up to turn on the pump. Try your pump in a different electrical outlet.</p> <p><b>AA BATTERIES</b></p> <p>Be sure the batteries have been inserted correctly as shown inside the breast pump base's battery compartment. Use new premium batteries (such as Energizer, Duracell.) Do not use batteries with AC power adapter plugged into side of pump base. If problem persists, you can test that the batteries work in another battery powered appliance.</p>
<p><b>"Lo" Notification on LCD Screen</b></p>	<p>When AA batteries are low, the LCD screen will display a "Lo" notification. You may then replace all batteries or use the AC Power Adapter.</p>
<p><b>"ERR" Notification on LCD Screen</b></p>	<ul style="list-style-type: none"> <li>• Make sure the AC Power Adapter is the correct electrical rating (Approved Ameda AC Power Adapter).</li> <li>• Replace the AC Power Adapter.</li> <li>• Contact Ameda at <b>1.866.992.6332</b></li> </ul>

If there are still questions or issues please call Ameda's certified customer service ParentCare team at **1.866.992.6332**.

**FCC STATEMENT**

This device complies with part 15 of the FCC Rules. Operation is subject to the following two conditions: (1) This device may not cause harmful interference, and (2) this device must accept any interference received, including interference that may cause undesired operation.

*Caution:* changes or modifications to this device are not expressly approved by Ameda may void the user's authority to use the device.

**Note:**

This equipment has been tested and found to comply with the limits for a Class B digital device, pursuant to part 15 of the FCC Rules. These limits are designed to provide reasonable protection against harmful interference in a residential installation. This equipment generates, uses and can radiate radio frequency energy and, if not installed and used in accordance with the instructions, may cause harmful interference to radio communications. However, there is no guarantee that interference will not occur in a particular installation. If this equipment does cause harmful interference to radio or television reception, which can be determined by turning the equipment off and on, the user is encouraged to try to correct the interference by one or more of the following measures:

- Reorient or relocate the receiving antenna.
- Increase the separation between the equipment and receiver.
- Connect the equipment into an outlet on a circuit different from that to which the receiver is connected.
- Consult the dealer or an experienced radio/TV technician for help.

## 11. WARRANTY

**THE AMEDA WARRANTY IS NONTRANSFERABLE BETWEEN INDIVIDUALS. THE AMEDA MYA JOY ELECTRIC BREAST PUMP ("PRODUCT") IS WARRANTED TO THE ORIGINAL USER – WHETHER INSTITUTIONAL OR INDIVIDUAL ("FIRST USER") – ONLY.**

From the date of the Individual User's purchase of this product, Ameda Company, Inc. ("Ameda") warrants the Product to the Individual User against defects in material or workmanship for a period of two years for the pump mechanism and 90 days on other pump components except for breast pump valves. Ameda's sole obligation under this limited warranty shall be to repair or replace, at Ameda's option, any Product that is determined to be defective by Ameda and determined to be covered by this express limited warranty. Repair or replacement under this limited warranty is the sole and exclusive remedy of the First User.

**PROOF OF PURCHASE IN THE FORM OF A RECEIPTED INVOICE OR BILL OF SALE EVIDENCING THAT THE PRODUCT IS WITHIN THE WARRANTY PERIOD MUST BE PRESENTED TO OBTAIN WARRANTY SERVICE.**

This limited warranty is extended by Ameda ONLY to the First User and is not assignable or transferable. For warranty service contact Ameda at 1.866.992.6332.

EXCEPT TO THE EXTENT PROHIBITED BY APPLICABLE LAW, ANY IMPLIED WARRANTY OF MERCHANTABILITY OR FITNESS FOR A PARTICULAR PURPOSE ON THE PRODUCT IS HEREBY DISCLAIMED. AMEDA SHALL NOT BE LIABLE FOR ANY INCIDENTAL, CONSEQUENTIAL, SPECIAL OR PUNITIVE DAMAGES OF ANY KIND FOR BREACH OF THE EXPRESS LIMITED WARRANTY ON THE PRODUCT OR ANY WARRANTY IMPLIED BY OPERATION OF LAW. OTHER THAN THE EXPRESS LIMITED WARRANTY SET FORTH ABOVE, THERE ARE NO OTHER WARRANTIES THAT ACCOMPANY THIS PRODUCT AND ANY ORAL, WRITTEN OR ANY OTHER REPRESENTATION OF ANY KIND IS HEREBY DISCLAIMED.

### **NON-APPLICABILITY OF WARRANTY**

In addition to any other limitations on the warranty discussed above, the warranty shall expire and be of no force or effect upon the occurrence of any of the following:

- (i) the cause of damage to the Product is due to improper handling or use.
- (ii) opening of the pump motor, modifications, self-repair or use outside the instructions in this manual voids warranty.
- (iii) the Product is not properly maintained by the Individual User as determined by Ameda.
- (iiii) non-Ameda approved accessories or spare parts are used with the Product as determined by Ameda.

If any of the above occurs, Ameda shall not be responsible for damage to the Product, parts thereof or injuries arising therefrom, either directly or indirectly. The warranty terms set forth above replaces all prior warranties with respect to the purchased Product, whether in writing or otherwise.

**Outside the United States:** Call your local distributor or location where you purchased the Product. For a listing of distributors in your country, please visit [www.ameda.com](http://www.ameda.com).

## 12. TECHNICAL DATA

### 12.1 Specifications

Product Description	Electric Breast Pump	
Model	Ameda Mya Joy	
Suction	Stimulation mode: Dual-Kit: 40 to 100 mmHg	
	Stimulation mode: Single-Kit: 80 to 160 mmHg	
	Expression mode: Dual-Kit: 50 to 250 mmHg	
	Expression mode: Single-Kit: 80 to 250 mmHg	
Vacuum Levels	Stimulation mode: 6 Levels	
	Expression mode: 12 Levels	
Cycles Per Minute	Stimulation mode: 80~120 C.P.M.	
	Expression mode: 20~65 C.P.M.	
Breastshield Sizes	25mm	
Power Source	Medical AC Adapter - Output: 6.0 VDC, 1000mA Input: 100-240VAC 50/60HZ	
	Four AA batteries, 1.5 V alkaline (NOT INCLUDED)	
Battery Life	Approximately 1.5 hours, different types of batteries may affect battery life	
Additional Function	Automatic Power-off after 45 min	
Unit Weight	Approx. 232.6g (8.2oz) - excluding battery Approx. 328.4 g (11.6oz) - including batteries	
Unit Dimensions	110 x 93 x 55mm (L x W x H)	
Operating Environment	Temperature: 5°C~40°C (41°F~104°F)	
	Humidity: 15~93%RH	
	Pressure: 70kPa~106kPa	
Storage Environment Transportation	Temperature: -20°C~55°C(-4°F~131°F)	
	Humidity: ≤93%RH	
Expected Service Life	Your device has been designed and developed with the greatest possible care and has an expected service life of 400 hours.	
Ingress Protection Rating	IP22	
Classification	Internal Powered Equipment, Type BF	
Protection Class	Class II/Double Insulated	

*Specifications are subject to change without notice.*

This appliance conforms to the following standards:

IEC 60601-1-11 Medical electrical equipment –Part 1-11: General requirements for basic safety and essential performance –Collateral Standard: Requirements for medical electrical equipment and medical electrical systems used in the home healthcare environment and complies with the requirements of IEC 60601-1-2(EMC), AAMI/ANSI ES60601-1(Safety) standards. And the manufacturer is ISO 13485 certified.

## 12.2 Electromagnetic Compatibility

**TABLE 1**

Guidance and declaration of manufacturer-electromagnetic emissions		
The device is intended for use in the electromagnetic environment specified below. The customer or the user of the device should assure that it is used in such an environment.		
Emissions test	Compliance	Electromagnetic environment - guidance
Radiated emission CISPR 11	Group 1, class B	The device uses RF energy only for its internal function. Therefore, its emissions are very low and are not likely to cause any interference in nearby electronic equipment.  The device is suitable for use in all establishments, including domestic establishments and those directly connected to the public low-voltage power supply network that supplies buildings used for domestic purposes.
Conducted emission CISPR 11	Group 1, class B	
Harmonic emissions IEC 61000-3-2	Class A	
Voltage fluctuations/ flicker emissions IEC 61000-3-3	Complies	

**TABLE 2**

Guidance and declaration of manufacturer-electromagnetic immunity (For home healthcare environment)			
The device is intended for use in the electromagnetic environment specified below. The customer or the user of the device should assure that it is used in such an environment			
IMMUNITY test	IEC 60601 test level	Compliance level	Electromagnetic environment - guidance
Electrostatic discharge (ESD) IEC 61000-4-2	± 8 kV contact ±2 kV, ±4 kV, ±8 kV, ±15 kV air	± 8 kV contact ±2 kV, ±4 kV, ±8 kV, ±15 kV air	Floors should be wood, concrete or ceramic tile. If floors are covered with synthetic material, the relative humidity should be at least 30 %.
Electrostatic transient/burst IEC 61000-4-4	± 2 kV , 100kHz, for AC power port	± 2 kV , 100kHz, for AC power port	Mains power quality should be that of a typical commercial or hospital environment.
Surge IEC 61000-4-5	±0.5kV, ±1kV (differential mode)	±0.5kV, ±1kV (differential mode)	Mains power quality should be that of a typical commercial or hospital environment.
Voltage dips, short interruptions and voltage variations on power supply input lines IEC 61000-4-11	0 % UT; 0,5 cycle At 0°, 45°, 90°, 135°, 180°, 225, 270° and 315° 0 % UT; 1 cycle and 70 % UT; 25/30 cycles Single phase: at 0° 0 % UT; 250/300 cycle	0 % UT; 0,5 cycle At 0°, 45°, 90°, 135°, 180°, 225°, 270° and 315° 0 % UT; 1 cycle and 70 % UT; 25/30 cycles Single phase: at 0° 0 % UT; 250/300 cycle	Mains power quality should be that of a typical commercial or hospital environment.
Power frequency (50/60 Hz) magnetic field IEC 61000-4-8	30 A/m; 50Hz or 60Hz	30 A/m; 50Hz or 60Hz	Power frequency magnetic fields should be at levels characteristic of a typical location in a typical commercial or hospital environment.

**TABLE 3**

Guidance and declaration of manufacturer-electromagnetic immunity. (For home healthcare environment)			
The device is intended for use in the electromagnetic environment specified below. The customer or the user of the device should assure that it is used in such an environment.			
IMMUNITY test	IEC 60601 test level	Compliance level	Electromagnetic environment guidance
Conducted RF IEC 61000-4-6	3V for 0.15- 80MHz; 6V in ISM and amateur radio bands between 0.15-80MHz	3V for 0.15-80MHz; 6V in ISM and amateur radio bands between 0.15-80MHz	Portable and mobile RF communications equipment should be used no closer to any part of the device, including cables, than the recommended separation distance calculated from the equation applicable to the frequency of the transmitter.
	385MHz, 27V/m	385MHz, 27V/m	
Radiated RF IEC 61000-4-3	450MHz, 28V/m	450MHz, 28V/m	Recommended separation distance 80MHz to 800MHz 800MHz to 2.7Ghz where P is the maximum output power rating of the transmitter in watts (W) according to the transmitter manufacturer and d is the recommended separation distance in metres (m).  Field strengths from fixed RF transmitters, as determined by an electromagnetic site survey, a should be less than the compliance level in each frequency range.  Interference may occur in the vicinity of equipment marked with the following symbol:
	710MHz, 745 MHz, 780MHz 9V/m	710MHz, 745Hz, 780MHz 9V/m	
	810MHz, 870MHz, 930MHz 28V/m	810MHz, 870Hz, 930MHz 28V/m	
	1720MHz, 1845MHz, 1970MHz 28V/m	20MHz, 1845Hz, 1970MHz 28V/m	
	2450MHz, 28V/m	2450MHz, 28V/m	
	5240MHz, 5500MHz, 5785MHz 9V/m	5240MHz, 5500Hz, 5785MHz 9V/m	
			

**TABLE 4**

Recommended separation distances between portable and mobile RF communications equipment and the device (For home healthcare environment)		
The device is intended for use in an electromagnetic environment in which radiated therefore disturbances are controlled. The customer or the user of the device can help prevent electromagnetic interference by maintaining a minimum distance between portable and mobile RF communications equipment (transmitters) and the device as recommended below, according to the maximum output power of the communications equipment.		
Rated maximum output power of transmitter W	Separation distance according to frequency of transmitter m	
	80MHz to 800MHz $d = \left[ \frac{3.5}{E_1} \right] \sqrt{P}$	800MHz to 2.7GHz $d = \left[ \frac{7}{E_1} \right] \sqrt{P}$
0.01	0.12	0.23
0.1	0.38	0.73
1	1.2	2.3
10	3.8	7.3
100	12	23
For transmitters rated at a maximum output power not listed above, the recommended separation distance d in metres (m) can be estimated using the equation applicable to the frequency of the transmitter, where P is the maximum output power rating of the transmitter in watts (W) according to the transmitter manufacturer.		
NOTE 1: At 80MHz and 800MHz, the separation distance for the higher frequency range applies.		
NOTE 2: These guidelines may not apply in all situations. Electromagnetic propagation is affected by absorption and reflection from structures, objects and people.		

### 12.3 Product Disposal

This product contains electrical and electronic equipment.



1. The internal components of this product may contain hazardous materials. Dispose of this product according to local or regional waste administration systems and regulations. Caution: Hazardous materials present in electric and electronic equipment may harm human health and the environment if the equipment is not properly disposed of.
2. Do not dispose of electric or electronic equipment together with unsorted municipal waste.
3. For further information regarding the environmental performance of this product please visit our website [www.ameda.com](http://www.ameda.com). The breast pump and parts are made of plastics which have an impact on the environment when disposed of. Please recycle according to local regulations.

### 13. OPERATIONAL & STORAGE CONDITIONS



Operational Conditions

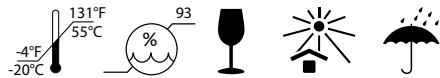

Transport/Storage Conditions

## 14. TRAVEL OR INTERNATIONAL USE



**WARNING:** Use **ONLY** the AC power adapter recommended for the Ameda Mya Joy Breast Pump. AC power adapters with Australia, United Kingdom, Europe or other international plug configurations are not intended for use in North America.

If you will be traveling outside of your country where you received your Ameda Mya Joy breast pump you will need to use batteries or a Ameda Mya Joy AC power adapter specific to that area of travel in order to use your breast pump while traveling.



**WARNING:** You could cause serious harm to yourself or damage the breast pump.

## 15. AMEDA ACCESSORIES AND SPARE PARTS

### SOME PUMPS MAY ALSO INCLUDE SOME OF THESE ACCESSORIES:

You may also be able to order these additional accessories or spare parts online, at a local Ameda retailer or Ameda insurance covered provider, visit [www.ameda.com](http://www.ameda.com) for more information.



Dottie Tote



Minnie Tote



AC Power Adapter



Cool'N Carry Milk Storage Tote



Cooling Element



Breast Milk Storage Bottles



Pump'N Protect 6oz Storage Bags



One-Hand Breast Pump



Bottle Holders



21.0 mm Flexishield™ Areola Stimulator



25.0 mm Breast Flange



28.5 mm Breast Flange



28.5 mm Insert/30.5 mm Breast Flange



32.5/36.0 mm Breast Flange



Valve



Diaphragm



Tubing



Tubing Adapter



Adapter Cap



Locking Ring



Locking Disk





**To register your pump:**

Please visit [ameda.com/register-your-pump](https://www.ameda.com/register-your-pump) and input the serial number (SN) from the bottom of your pump.

Distributed in USA by:  
Distribué aux États-Unis par :  
Distribuido en los EE. UU. por:  
**Ameda, Inc.**  
485 Half Day Road  
Buffalo Grove, IL 60089  
1.866.992.6332

Distribution in other countries: For product information or feedback, call your local distributor or location where you purchased the product. For a listing of distributors in your country, please visit [www.ameda.com](https://www.ameda.com).

 Distributed by:  
**Ameda Inc.**  
485 Half Day Road  
Suite 320  
Buffalo Grove, IL 60089