

ActiveAid

1218

OWNER'S MANUAL



Please ensure the Owner's Manual stays with the unit at all times.

SYMBOL LEGEND



CAUTION/ATTENTION



DATE OF MANUFACTURE

SN

SERIAL NUMBER



SEE INSTRUCTIONS FOR USE



Please be environmentally responsible and recycle this product through your recycling facility at its end of life.

Afin de préserver l'environnement, veuillez confier ce produit à votre centre de recyclage à la fin de sa durée de vie.



MANUFACTURER

Table of Contents

| | |
|---------------------------------|----------|
| Introduction | 1 |
| Safety Precautions | 2 |
| Assembly | 3 |
| Usage | 7 |
| Trouble Shooting | 7 |
| Maintenance | 8 |
| Limited Warranty | 9 |



Serial number is located on the frame.

Date Purchased: _____

Serial#: _____

Model #: _____

Supplier: _____

Introduction

CONGRATULATIONS! You have selected one of our many fine mobility products. Your Shower/Commode Chair has been carefully designed and fabricated focusing on customer needs.

Shower/Commode Chair Description

ActiveAid shower and commode products are intended for individuals who are able to transfer independently or with assistance from a caregiver. They are a useful tool for rehabilitation or home use. ActiveAid shower and commode products can be individually configured to meet the specific needs of an individual.

Indications for Use

The **Shower/Commode Chair** is indicated for most individuals weighing up to:

| | |
|--------------------------|--------------------------|
| 12"x12" 150 lbs. (68kg) | 14"x14" 250 lbs. (113kg) |
| 16"x16" 300 lbs. (136kg) | 18"x18" 350 lbs. (158kg) |

Intended Use

ActiveAid shower and commode products are intended to assist disabled individuals in performing activities of daily living (toileting and bathing).

This device is designed and intended for shower/commode use in accessibility compliant environments. Accessibility compliant environments generally outline that flooring surfaces are to be stable, firm and slip resistant. If ground and floor surfaces are encountered that are not within the appropriate accessible standards, the area in question should be brought within the code for disability accessibility before using the device.

This manual is an integral part of your Shower/Commode Chair product and should be read completely and thoroughly by anyone that will be operating the unit. This will ensure the product is assembled properly and used in the most beneficial manner.

The ActiveAid 1218 should only be used under the guidance of a physician or therapist. Consult your physician or therapist for proper transfer techniques.

Should any problem arise that you cannot solve by reading this manual, please contact your local supplier or call ActiveAid, LLC at 1-800-533-5330 or 1-507-644-2951.

It is necessary to inspect your Shower/Commode chair at least weekly to ensure it is in safe operating condition. Adjustments that are listed in the product owner's manual can be made by the operator by following the instructions for use. After an adjustment is made, inspect the unit to ensure all hardware and adjustable components are properly secured per the instructions for use. Replacement of worn parts, major adjustments, or any other important corrections should be handled by an authorized supplier. Only ActiveAid, LLC approved replacement parts should be used to ensure safety and performance.

THANK YOU FOR BUYING AN ACTIVEAID PRODUCT!

Safety Precautions

- Please read and understand all safety precautions and user instructions prior to use. Call ActiveAid at 1-800-533-5330 or 507-644-2951 with questions or concerns.
- The **Shower/Commode chair** is designed to accommodate most individuals up to:

| | |
|--------------------------|---------------------------|
| 12"x12" 150 lbs. (68kg) | 14"x14" 250 lbs. (113kg) |
| 16"x16" 300 lbs. (136kg) | 18"x18" 350 lbs. (158kg). |
- The expected service life of a 1218 product is 3 years under normal use conditions. *Note: this may vary based on frequency of use.*
- ActiveAid products are specifically designed to be used with ActiveAid accessories and options. Unless otherwise noted, accessories and options from other manufacturers have not been tested by ActiveAid and are not recommended for use with ActiveAid products.
- Product modifications made without express written consent (including but not limited to, modification through the use of unauthorized parts or attachments) are not recommended and will void the product warranty.
- This equipment is designed to accommodate a range of users; therefore, the unit has various adjustment slots and holes. Avoid placing fingers or other body parts in any of these areas.
- Do not make height adjustments while seated.
- Please dispose of packaging materials properly. Keep plastic bags away from children.
- ActiveAid shower/commode chairs are designed for indoor use only.
- Do not submerge the shower/commode chair.
- Extreme movements laterally or front to back may cause the unit to tip. These movements will cause a change to the normal center of gravity of the chair.
- When transferring or re-positioning in the chair, ensure casters are properly aligned (front casters in forward position, rear casters positioned to the rear) and wheel locks/caster locks are locked (as applicable to the configuration of the selected product).
- Do not use foot plates in the transfer process or when shifting your weight.
- Wheel locks/caster locks are intended to keep the shower/commode chair stationary during transfer or use. They are not intended to be used as brakes to slow and stop a moving shower/commode chair.
- Do not remove the anti-tip levers, they provide rearward stability.

 • **Caution: Check all fasteners before operating.**

 • **Caution: It is necessary to periodically check all fasteners (snap buttons, screws, nuts, bolts, clips, pull pins, handles, etc.) to ensure they are secure.**

Assembly

Tools required for setup: 7/16" wrench, 5/32" hex key, #10 metric wrench.

Note: Assembly may include some or all these steps based on shipping configuration and options of the product selected.

1. Remove all parts from the shipping container(s). Remove all packing material from the parts. Recycle shipping and packing materials in accordance with the recycling codes of your location.

If the pediatric leg rests were ordered, insert the ends into the receiver of the front support as shown, place in desired position and insert pin.

Repeat for second leg rest, if ordered.



2. If the elevating or gooseneck leg rests were ordered, insert the ends (with the pin) into the receiver of the front support.

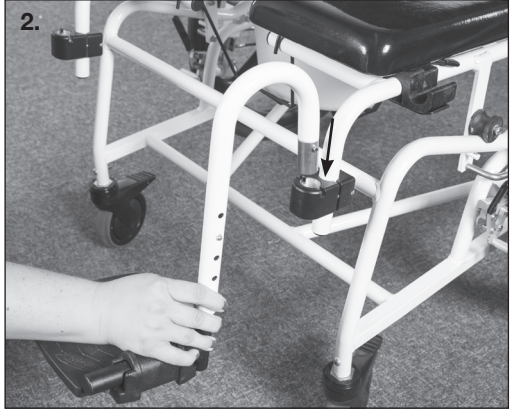

3. Push down to secure the leg rest into the front support.

Repeat for second leg rest, if ordered.



4. If the large head support was ordered, remove acorn nut and clamp from headrest assembly.

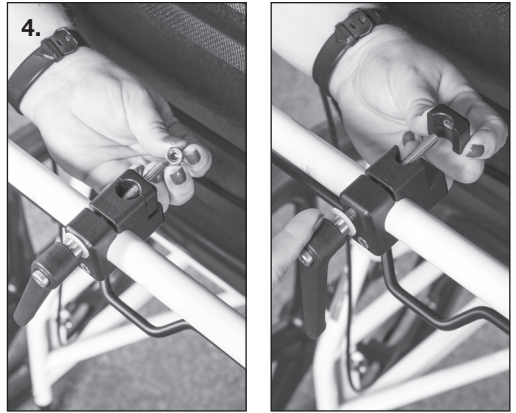

5. Unscrew ratchet handle until there is room to insert the head support stem. Insert head support stem.



6. Place clamp back into position.



7. Place acorn nut back onto bolt and tighten securely.



8. If the small foam head support was ordered, place it onto the back as shown.

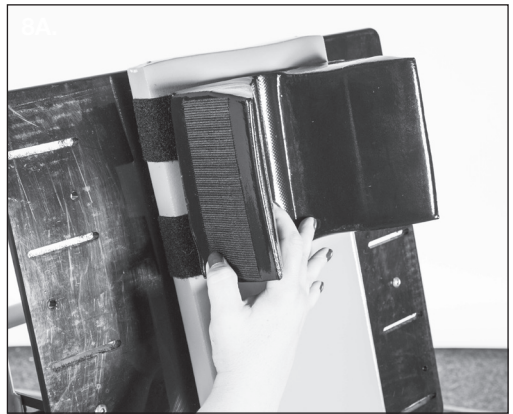

9. If the Abductor/Deflector was ordered, insert into the opening of seat as shown.



Usage

Seat

Remove by lifting one corner at a time or lift off one side only and pivot the seat up from the opposite side. Install the seat by aligning opposite corners and snapping into place on the frame. Make sure that the seat is square, and all 4 corners are snapped into place before sitting on chair.

Adjustable Sling Back

Loosen strap thru buckle to decrease tension, tighten strap thru buckle to increase tension

Leg Rests

Gooseneck

Adjust the height of the leg rest by depressing snap button and sliding footplate mount up or down to obtain correct height. Remove footrest assembly by lifting on the gooseneck to remove it from the receiver of the front support.

Elevating Leg Rest

Adjust the height of the leg rest by depressing snap button and sliding footplate mount up or down to obtain correct height. Adjust the angle of the leg rest upward by lifting, lower by depressing the tab.

Arm Rests

Height-Adjustable Arm Rests

To raise the arm, push up on the armlock cap and pivot back the entire armrest. To lower the arm, pull down on the front of the armrest until the arm latch locks onto the securing stud under the arm pivot.

Flip-Up Arm Rests

To raise the arm up, pivot the arm lock lever away from the armrest and armrest lock. Lift up on the armrest. Remove by depressing the snap button and sliding it out of the armrest pivot.

Tilt Function

Adjust the tilt-in-space angle position of the device by lifting on the lock release handle to disengage the locking mechanisms. Lift up or push down on the handle of the back assembly to tilt the device to the position. Release the lock release handle to lock and secure the device in place.

Head Support

Adjust height of headrest by loosening ratchet handle, sliding up and down, and re-tightening once desired position is reached.

Adjust position of headrest by loosening the screws on the back with hex key (near the ball joint). Once in preferred position, retighten the screws to hold in position.

Casters

Locking casters: To lock casters (option), push down on the front of the caster brake lever. To release caster brake, push down on the rear of the caster brake.

Removing Casters: Loosen then remove the self-locking nut and machine screw that are in the chair frame where the casters will be inserted. Insert caster so that it is flush with the frame. Re-insert the screw through the holes in the chair frame and caster stem. *Note: Screw head should be to the outside of the frame and the nut to the inside.* Hand start the nut onto the end of the screw Use a wrench and hex key to tighten the casters into place. Repeat for second caster.

Usage (cont.)

Belts

Hook and Loop Fasteners

Pull the belt strips apart to separate them. Adjust the strips to the proper position. Press the belt strips together to connect them.

Snap Fit Buckle

To unbuckle, depress the two spring arms on the male end and pull/slide to separate it from the female receiver. To buckle, insert the male end into the female receiver until the spring arms secure. Listen for clicking sound to indicate it is secure. Pull strap thru male portion of buckle to tighten.

Abductor/Deflector

Slide deflector into the front opening of the seat.

Swing Away Adjustable Laterals

To swing the lateral back out of the way, depress the button, pull lateral back around behind the back. To make width adjustments, loosen screws, slide lateral left or right in bracket to desired position, tighten screw.

Arm-Mounted Hip Guides

To adjust forward/rear position, slightly loosen front/rear knob and slide assembly forward/backward to desired position, tighten knobs. To adjust width, slightly loosen middle two knobs, push/pull assembly in/out to desired position, tighten knobs.

Check all fasteners (snap buttons, screws, nuts, bolts, clips, pull pins, handles, etc.) for tightness and make sure they are secure.

Trouble Shooting

The lock release mechanism is not locking properly.

Loosen the top tension adjustment nut, lower the bottom tension adjustment nut one-half (1/2) of a turn, and tighten the top tension adjustment nut to properly secure both tension adjustment nuts in place.

If the lock release mechanism continues to not lock properly, repeat the adjustment process as previously described above in this paragraph until the lock release mechanism engages “locking” and locks the tilt-in-space seating system in place.

The lock release mechanism is not releasing properly.

Loosen the top tension adjustment nut, raise the bottom tension adjustment nut one-half (1/2) of a turn, and tighten the top tension adjustment nut to properly secure both tension adjustment nuts in place.

If the lock release mechanism continues to not release properly, repeat the adjustment process as previously described above until the lock release mechanism engages “tilting” and releases the tilt-in-space seating system.



Maintenance

- It is necessary to inspect your Shower/Commode chair at least weekly to ensure it is in safe operating condition.
- Check all fasteners (snap buttons, screws, nuts, bolts, clips, pull pins, handles, etc.) to ensure they are present and secure.
- Check upholstery for tears and cracks.
- Check belts for fraying, cuts, tears, broken/worn stitching and buckles for cracks or damage.
- Check casters for cracks and wear.
- Check caster locks for tightness and proper function.
- Replace damaged or worn components. Contact your Supplier for repair/replacement of said parts before continuing use of the shower/commode chair.
- Use only recommended ActiveAid replacement parts; use of any other parts may void your warranty and cause damage to your device.

Cleaning/Disinfecting

- After each shower use, rinse the device with water to remove soap residue. Using a soft non-abrasive cloth or sponge, wipe the device down to remove water accumulation and product build up. Allow to dry completely before storing.
- When cleaning the unit, use a mild detergent with a soft non-abrasive cloth or sponge. Do not use harsh cleaning solvents or an abrasive cleaning agent.
- Upholstery pads may be cleaned with a non-abrasive, non-alcohol-based soap or sanitized using a bleach dilution of up to 1:10. Note, many anti-bacterial and disinfectant products contain alcohol and should not be used on the upholstery, due to the drying effect of the alcohol. Choose a non-alcohol-based sanitizer. Germicidal wipes that are rated to kill C-difficile spores may be used on the upholstery and the epoxy coated stainless steel.
- Urethane Coated Fabrics may be cleaned with a sponge or damp cloth to wipe the surface clean with warm water. As needed, they may be hand washed using warm water and a mild detergent. Do not use bleach. Line dry. Do not iron. Do not dry clean.

Parts Replacement

When asking your supplier to order replacement parts, please specify the serial number of the 1218 unit. Your Supplier will contact ActiveAid Customer Service to obtain the necessary items for your specific unit.

If you have any questions, please contact your local supplier or call ActiveAid, LLC at 1-800-533-5330 or 1-507-644-2951.

Limited Warranty

This warranty is extended only to the original purchaser/customer (or supplier non consumer who does not buy or resell). ActiveAid, LLC, warrants the 1218 against defects in materials and workmanship as listed below.

- Stainless Steel Frames – 3 year warranty
- Brake mechanisms, locking mechanisms, wheels and casters – 1 year warranty
- Other metal and structural parts not of stainless steel--1 year warranty
- Upholstered components, plastic pads, rubber parts, painted surfaces, bearings and other parts not specifically identified above – 6 months warranty

The warranty period commences on the original ship date from ActiveAid. Any product proven to ActiveAid's satisfaction to be defective and within warranty period shall be repaired or replaced at ActiveAid's option.

ACTIVEAID's SOLE OBLIGATION AND YOUR EXCLUSIVE REMEDY UNDER THIS WARRANTY SHALL BE LIMITED TO SUCH REPAIR AND/OR REPLACEMENT. This warranty does not include any labor charges incurred in replacement parts installation. For warranty service, please contact the authorized supplier from whom you purchased your ActiveAid product. In the event you do not receive satisfactory warranty service, please contact ActiveAid at the address below. Do not return products to our factory without prior authorization.

LIMITATIONS AND EXCLUSIONS: The foregoing warranty shall not apply to serial numbered products if the serial number has been removed or defaced. Products subject to negligence, abuse, misuse, improper maintenance, improper storage, or damages beyond ActiveAid's control are not covered by this warranty, and that evaluation will be solely determined by ActiveAid. Products modified without ActiveAid's express written consent (including but not limited to, modification through the use of unauthorized parts or attachments) are not covered by this warranty. The warranty shall not apply to problems arising from normal wear or failure to follow instructions. The warranty will be void if parts not manufactured by ActiveAid or parts not complying with original equipment specifications are added to an ActiveAid product.

THE FOREGOING WARRANTY IS EXCLUSIVE AND IN LIEU OF ALL OTHER EXPRESS WARRANTIES. ACTIVEAID SHALL NOT BE LIABLE FOR ANY CONSEQUENTIAL OR INCIDENTAL DAMAGES WHATSOEVER.

ActiveAid maintains a policy of continual product improvement and reserves the right to change features, specifications, and prices without prior notification. Check with ActiveAid for latest information.



ActiveAid, LLC.

101 Activeaid Road • Redwood Falls MN 56283 USA
800•533-5330 • PH (507) 644-2951 • FAX (507) 644-2468 • customerservice@activeaid.com
activeaid.com