



285TR

Available in
Black or White

Rehab Shower/Commode Chair- Tilt, Recline, and Seat Height Adjustment

- Packages Now Available
- Stainless Steel Frame
- Several New Seat Options Available
- Tilt, Recline and Seat Height Adjustment
- Seven Seat and Frame Sizes:
16"Wx18"D, 18"Wx18"D, 18"Wx20"D, 20"Wx18"D, 20"Wx20"D,
22"Wx18"D, 22"Wx20"D

This tilt-in-space shower/commode chair with stainless steel frame comes with an optional reclining back and tool-free, 4-way seat. The combination of tilt-in-space and recline easily accommodates complex positioning needs.

Multiple features combine to provide support, comfort, and pressure relief along with the other benefits of tilt-in-space technology. The chair height adjustment allows for over toilet use or can be used with a commode pan, making this chair a versatile answer for home or institutional use.



FRAMES



P13762
16"Wx18"D
Stainless Steel
Frame



P13763
18"Wx18"D
Stainless Steel
Frame



P13764
18"Wx20"D
Stainless Steel
Frame



P13765
20"Wx18"D
Stainless Steel
Frame



P13766
20"Wx20"D
Stainless Steel
Frame



P13767
22"Wx18"D
Stainless Steel
Frame



P13768
22"Wx20"D
Stainless Steel
Frame

FRAME POSITIONING



P13759
Tilt



P13760
Recline



P13761
Tilt/Recline

CASTERS



60800-4
5" Dual Locking
Casters
(2 pair)



P13770
5" Casters (pair) and
5" Dual Locking
Casters (pair)

SEATS

*Seat works in all 4 positions



P61124
16"Wx18"D
Ensolite® 1" foam
Front Open Seat
A-4.75"xB-7.75" opening



P60993*
18"Wx18"D
Comfortuff 1.5" waterfall foam
Front/Rear Open Seat
A-5"xB-8" opening



P60974
18"Wx18"D
Comfortuff sloped foam
Front Open Seat
A-4"xB-6.5" opening



P61058
18"Wx18"D
Ensolite® 2" waterfall foam
Front Open Contoured Seat
A-5.5"xB-8.25" opening



P61086
18"Wx18"D
Ensolite® 2" foam
Solid Seat



P61122
18"Wx20"D
Ensolite® 1" foam
Solid Seat



P61121
18"Wx20"D
Ensolite® 1" foam
Front/Rear Open Seat
A-4.5"xB-7.5" opening



PP61038
18"Wx20"D
Comfortuff
1.5" waterfall foam
Side Open Seat
A-5"xB-8" opening



P61038
20"Wx18"D
Comfortuff
1.5" waterfall foam
Front Open Seat
A-5"xB-8" opening



PP60903
18"Wx20"D
Ensolite® 1" foam
Front/Rear Open Seat
A-4.5"xB-7.75" opening



PP61121
20"Wx18"D
Ensolite® 1" foam
Side Open Seat
A-4.5"xB-7.5" opening



PP61122
20"Wx18"D
Ensolite® 1" foam
Solid Seat



P61123*
20"Wx20"D
Ensolite® 1" waterfall foam
Front/Rear Open Seat
A-5"xB-8" opening



P60905
22"Wx18"D
Ensolite® 1" foam
Front/Rear Open Seat
A-4.5"xB-7.75" opening



P61126
22"Wx22"D
Ensolite® 1" waterfall foam
Front/Rear Open Seat
A-5"xB-8" opening

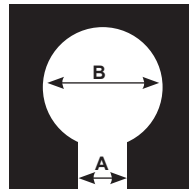

**Seat Opening
Measurements**

ARMRESTS



P13729
18"D Left Hand
Armrest with Pad



P13730
18"D Right Hand
Armrest with Pad



P13731
18"D Left Hand
Armrest with
Arm Trough



P13732
18"D Right Hand
Armrest with
Arm Trough



P13735
20"D Left Hand
Armrest with Pad



P13736
20"D Right Hand
Armrest with Pad



P13737
20"D Left Hand
Armrest with
Arm Trough

LEG RESTS



P13738
20"D Right Hand
Armrest with
Arm Trough



P13615
Left Hand
Height-Adjustable
Arms



P13616
Right Hand
Height-Adjustable
Arms

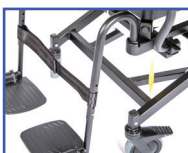

PL13725
Left Leg Rest



PR13725
Right Leg Rest



P13571
Left Elevating
Leg Rest



P13572
Right Elevating
Leg Rest

FOOT PLATES



PL11099
Left Foot Plate



PR11099
Right Foot Plate



PL11100
Left Foot Plate with
Heel Loop



PR11100
Right Foot Plate
with Heel Loop



P61137
Left Oversized
Aluminum
Foot Plate



P61138
Right Oversized
Aluminum
Foot Plate



PL11101
Left Padded
Foot Plate

BACKS



PR11101
Right Padded
Foot Plate



P13745
16\"/>



P13746
16\"/>

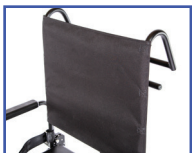

P13747
18\"/>



P13748
18\"/>



P13750
20\"/>



P13751
20\"/>

BELTS



P13752
22\"/>



P13753
22\"/>



PW60884
Waist Belt
(48\"/>



PT60910
Trunk Belt
(48\"/>



P60879
Calf Strap



P11093
Bodypoint®
Trunk Belt



P11102
Bodypoint®
Trunk Belt (pair)

POSITIONING AIDS



P11116
Bodypoint® Trunk
Belt & Waist Belt



P11112
Bodypoint® XL
Trunk Belt



P11113
Belt w/Quick
Release Knobs



P61081
Bodypoint®
Calf Strap



P11114
Bodypoint®
Knee Belt

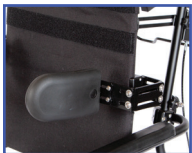

PL13574
Left Hand
Swing-Away
Adjustable Lateral



PR13574
Right Hand
Swing-Away
Adjustable Lateral

PANS



PL13618
Left Hand
Arm-Mounted
Hip Guide



PR13618
Right Hand
Arm-Mounted
Hip Guide



P61006
Abductor/Deflector
Small



P13754
16\"/>



P13376
18\"/>



P13755
18\"/>



P13719
20\"/>

HEAD SUPPORTS



P13756
20\"/>



P13720
22\"/>



P13757
22\"/>



P13621
Head Support
Large



P13758
Head Support
XL

full option details at
activeaid.com

PKG210 Package #2 - 18"W x 18"D

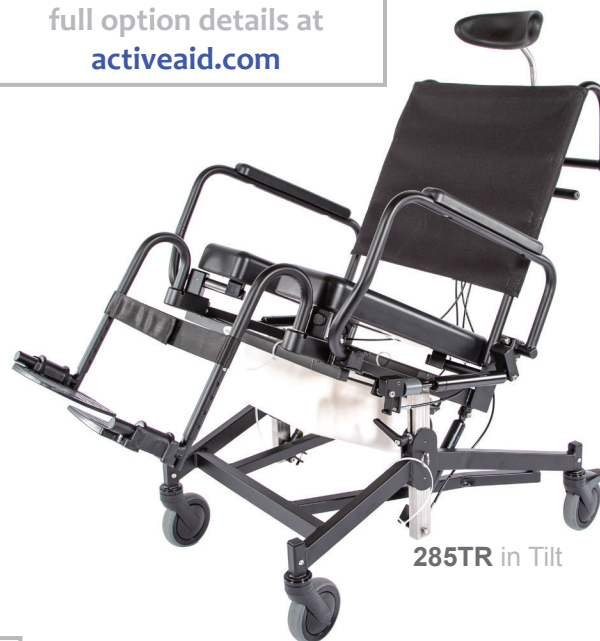

285TR in Tilt

SPECIFICATIONS

*specifications measured off 18"x18" Frame

Weight Capacity	350 lbs
Seat Width	18"
Width between Arm Rests	
Flip-Up With Pad	22"
Arm Troughs	20"
Height Adjustable	21.5"
Seat Depth	18"
Seat Height From Floor (or Range) to top of seat (transfer height)	22"-25"
Usable Seat Depth w/solid back	16"
Leg Rest Range	
Gooseneck	16"-20"
Elevating Up/Down	16.5"-23.5"
Arm Height from Top of Seat	
Flip-Up With Pad	8"
Arm Troughs	8.25"
Height Adjustable	4"-14"
Back Height From Top of Seat	22"
Gap between top of seat and bottom of back	4"
Maximum Back Slack	3"
Seat to Back Angle (or Range) (Recline)	0-40°
Tilt Range	0-26°
Head Support Height Range - top of Seat to bottom of Cervical Support	22.5"-30.5"
Under Seat Height Clearance	17.75"
Under Seat Width Clearance	16"
Overall Width - for each frame (min would have second spec for folding)	
	26" (with adj. height armrests)-31" (with arm troughs)
Overall Length - for each frame	42"-66"
Back of Unit to Start of Commode opening	15"
Turning Radius	26.5"