

# Dexcom G6

## Continuous Glucose Monitoring (CGM) System

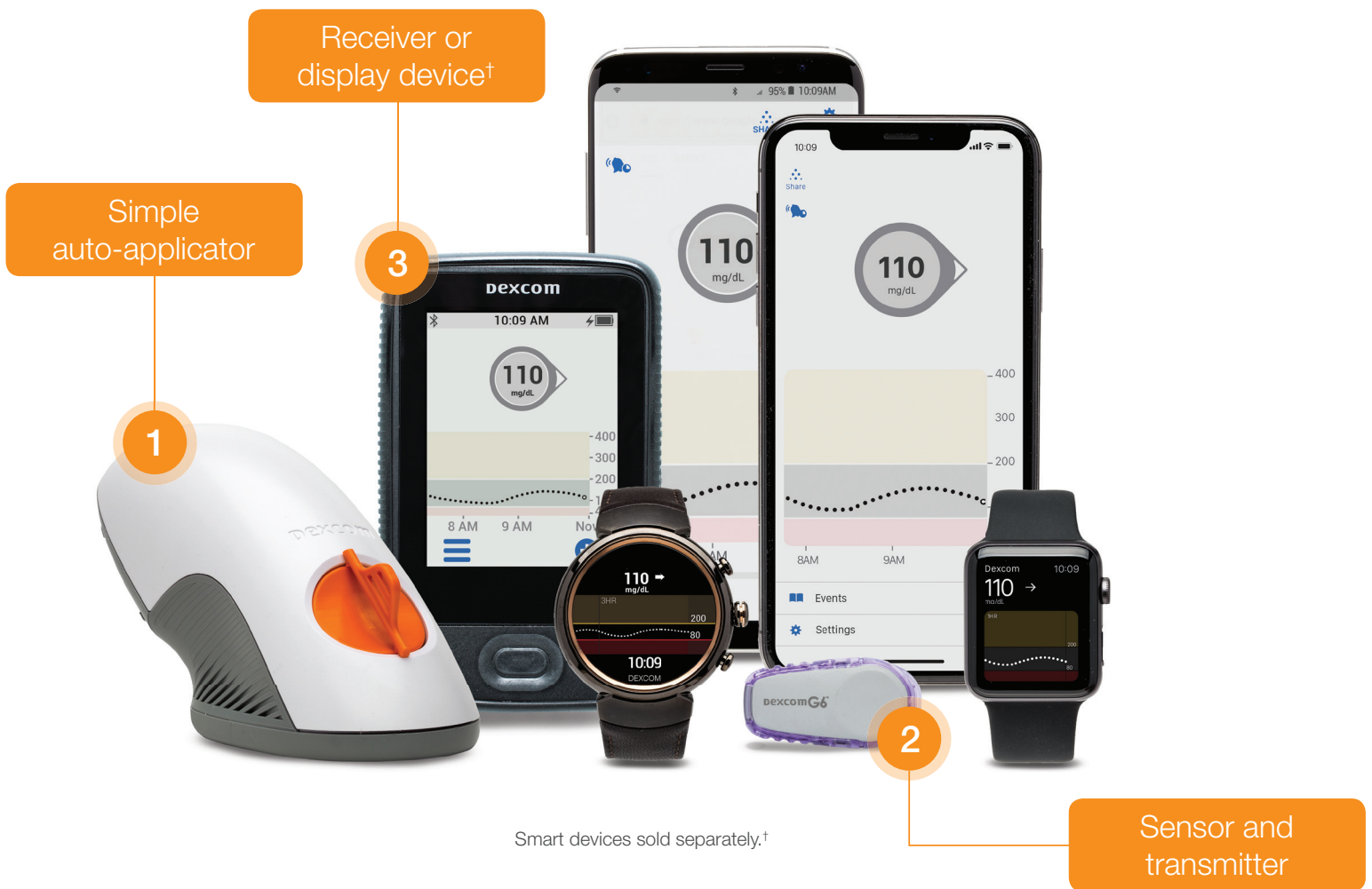

### — Important Information for Pharmacists —

Dexcom G6 is a real-time continuous glucose monitoring (RT-CGM) system that sends glucose readings to a compatible smart device† or the Dexcom receiver every five minutes. It is FDA-permitted for making diabetes treatment decisions with zero fingersticks and no calibration.\*

\*If a patient's glucose alerts and readings from Dexcom G6 do not match symptoms or expectations, they must use a blood glucose meter to make diabetes treatment decisions.

†For a list of compatible smart devices, visit [dexcom.com/compatibility](https://dexcom.com/compatibility).

# The Dexcom G6 CGM System

## Contains Three Components

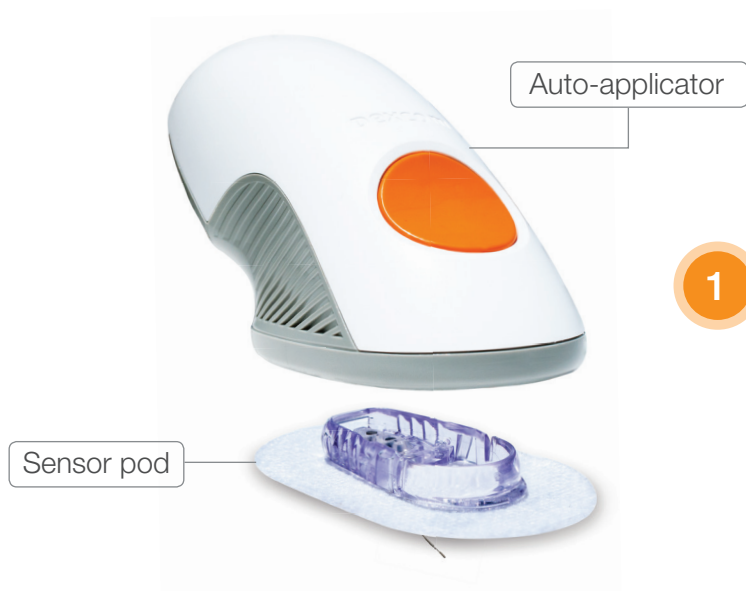

1

The **sensor** measures glucose levels from just underneath the skin. The simple **auto-applicator** is a one-touch applicator that easily inserts a small built-in sensor just beneath the skin. One sensor can be used for up to 10 days. The sensor kit is available in a 3-pack for a 30-day supply.

The **transmitter** is fastened on top of the sensor and wirelessly sends data to the receiver or compatible smart device. One transmitter is provided per pack. A transmitter can be used for up to three months.

2



3

The **receiver** is a display device that shows glucose levels and trends. Some patients may opt to use a compatible smart device.\* Patients may be eligible for a new receiver once per year, or every five years with Medicare.



\*For a list of compatible smart devices, please visit [dexcom.com/compatibility](http://dexcom.com/compatibility). Medicare patients are required to use a receiver compatible with Dexcom G6, even if they also choose to use a smart device.

View an informational video for pharmacists at  
[www.dexcom.com/pharmacist-video](http://www.dexcom.com/pharmacist-video)

# Patient Counseling and Access Tools

## *for Pharmacists*

### Filling a Dexcom G6 Pharmacy Prescription

#### **How do I fill a Dexcom G6 prescription?**

The first prescription includes 3 items: 1 receiver, 1 wireless transmitter, and 1 three-pack of sensors (30 days) or 3 three-packs of sensors (90 days). The receiver is indicated for 1-year use or 5 years for Medicare patients, the wireless transmitter is indicated for 3-month use, and each sensor is indicated for 10-day use. See below for information on how to order Dexcom supplies. Patients who do not have a pharmacy benefit can follow up with Dexcom for a durable medical equipment (DME) benefit coverage check at 1-888-738-3646.

#### **How do I order Dexcom G6?**

Dexcom G6 is available for order through all major wholesalers listed on the back cover. See Important Ordering Information on the back cover. For questions please call 1-888-738-3646.

#### **Are there any contraindications?**



The Dexcom G6 CGM System is contraindicated for use in magnetic resonance imaging (MRI), computed tomography (CT) scan, or high-frequency electrical heat (diathermy) treatment as this may damage components of Dexcom G6.

#### **Are there any drug interactions?**

Taking hydroxyurea or taking higher than the maximum dose of acetaminophen (>1 gram every 6 hours in adults) may affect sensor readings, making them look higher than they are. Patients should not use their Dexcom CGM System for diabetes treatment decisions if they are taking hydroxyurea. Patients can take standard doses of acetaminophen and still use sensor readings to make diabetes treatment decisions.<sup>†</sup>

<sup>†</sup>If a patient's glucose alerts and readings from Dexcom G6 do not match symptoms or expectations, they must use a blood glucose meter to make diabetes treatment decisions.

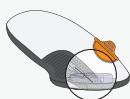
## Important Ordering Information

Dexcom G6 System Product Description	NDC	Cardinal Order Numbers	McKesson Order Numbers	AmerisourceBergen Order Numbers
 Dexcom G6 Sensor kits	08627-0053-03	5447552	3788858	10186959
 Dexcom G6 Transmitter kits	08627-0016-01	5447545	3788841	10186958
 Dexcom G6 Receiver kits	08627-0091-11	5447537	3788783	10186954

### BRIEF SAFETY STATEMENT

Indications for Use: The Dexcom G6 Continuous Glucose Monitoring System (G6) is an autonomous, real-time, continuous glucose monitoring device indicated for the management of diabetes in persons age 2 years and older. The glucose measurements are intended to replace fingerstick blood glucose testing for diabetes treatment decisions and behavioral modifications. The G6 can communicate wirelessly to and from other interoperable devices. Contraindication: Do not wear your G6 (sensor, transmitter, receiver, or smart device) for magnetic resonance imaging (MRI), computed tomography (CT) scan, or high-frequency electrical heat (diathermy) treatment. It is MR Unsafe. Warning: Failure to use the Dexcom G6 Continuous Glucose Monitoring System (G6) and its components according to the instructions for use provided with your device and available at <https://www.dexcom.com/safety-information> and to properly consider all indications, contraindications, warnings, precautions, and cautions in those instructions for use may result in you missing a severe hypoglycemia (low blood glucose) or hyperglycemia (high blood glucose) occurrence and/or making a treatment decision that may result in injury. If your glucose alerts and readings from the G6 do not match symptoms or expectations or you're taking over the recommended maximum dosage amount of 1000mg of acetaminophen every 6 hours, use a blood glucose meter to make diabetes treatment decisions. Seek medical advice and attention when appropriate, including for any medical emergency.

# Dexcom