

# PROVOX<sup>®</sup> Brush

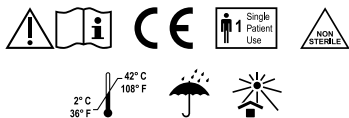

# Atos

Atos Medical Your voice

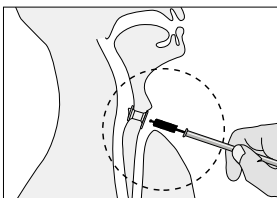
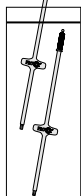

1	2	3	4	5	6	7
8	9	10	11	12	13	14
15	16	17	18	19	20	21
22	23	24	25	26	27	28
29	30					

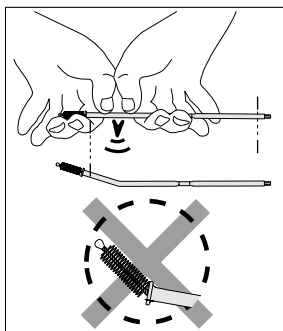

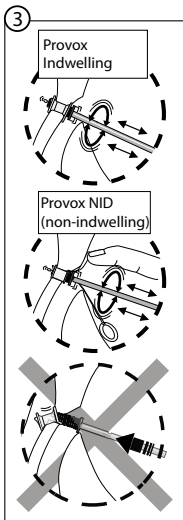
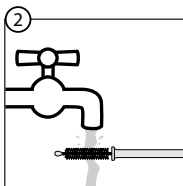
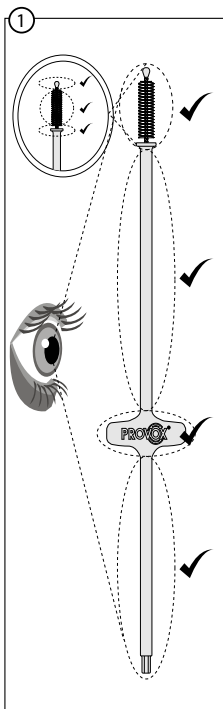

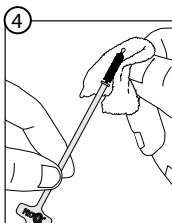

2 / 250 ml (8,5 fl oz)

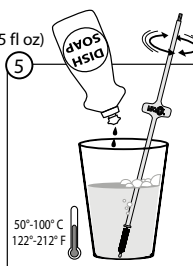

50°-100° C  
122°-212° F

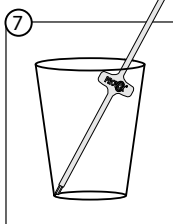
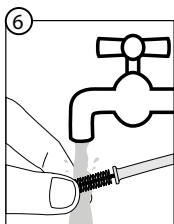

8

☾ ✨ ✨ x1



70 % Ethanol  10 min

or

70 % Isopropylalcohol  10 min

or

3 % Hydrogenperoxide  60 min

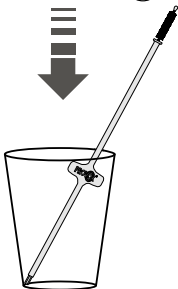

## **Disclaimer**

Atos Medical offers no warranty - neither expressed nor implied - to the purchaser hereunder as to the lifetime of the product delivered, which may vary with individual use and biological conditions. Furthermore, Atos Medical offers no warranty of merchantability or fitness of the product for any particular purpose.

## **Patents and trademarks**

Provox<sup>®</sup> is a registered trademark owned by Atos Medical AB, Sweden. For information about patents, please refer to the webpage [www.atosmedical.com](http://www.atosmedical.com).

## Contents

ENGLISH .....	8
DEUTSCH .....	10
NEDERLANDS.....	12
FRANÇAIS .....	14
ITALIANO.....	16
ESPAÑOL .....	18
PORTUGUÊS.....	20
SVENSKA .....	22
MAGYAR .....	24
POLSKI.....	26
РУССКИЙ .....	28
日本語 .....	30
한국어 .....	32
עברית .....	35
العربية .....	37
ORDERING INFORMATION.....	38

The manual, which accompanies this product, may be revised from time to time and must therefore be reviewed prior to each procedure in which the product is used.

## **Before use**

Always inspect the Provox Brush (fig. 1) to make sure that it is not broken or worn out. Especially inspect the following:

Make sure that

- the protective tip is not cracked or loose.
- the bristles do not appear worn or are loose.
- the wires are not bent or broken.
- the entire handle is not cracked or broken and that the safety wings have not been removed.

If any faults are found during this check, the brush must be discarded and not used.

## **Cleaning and disinfection**

Clean the Provox Brush after each use according to fig. 4-7.

Do not use any water other than drinking water to clean and rinse the device.

Disinfect the Provox Brush at least once a day (fig. 8) with one of the following methods:

- Ethanol 70% for 10 minutes
- Isopropylalcohol 70% for 10 minutes
- Hydrogenperoxide 3% for 60 minutes



**Caution:** Do not clean or disinfect by any other method as this might cause product damage and injury.

If the Provox Brush looks dirty or has air dried in an area with a risk of contamination the device should be both cleaned and disinfected before use. A risk of contamination could exist if the device has been dropped on the floor or if it has been in contact with a pet, someone with a respiratory infection, or any other gross contamination.

During hospitalization it is important to both clean and disinfect the Provox Brush after use but also **before** use since there is an increased risk of infection and contamination. In a hospital it is better to use sterile water for cleaning and rinsing, rather than drinking water.