

SMART CAREGIVER CORPORATION



- Stand-Alone Motion Sensing Exit Alarm with swivel bracket
- Use for bedside, hallways and doorways
- Chime Alert

## Motion Sensing Exit Alarm

### TL-2700

## Installation and Use Instructions

### TL-2700 Motion Sensing Exit Alarm

**IMPORTANT INFORMATION:** Cordless and Wireless Systems rely on wireless technology which is subject to physical and environmental considerations. Please be aware that the transmitter will not be 100% accurate if it is out of range at any time. It is the end-user's responsibility to make sure that the product is used correctly and within range of each other. Cordless and wireless systems and devices are intended as an adjunct to good caregiving practices and are not a substitute for proper staffing and patient management practices. We recommend that all caregivers receive periodic training in the operation of these systems and that the devices are tested daily. It is important to read and follow the directions.

**Read the instructions and Legal Disclaimer.**

The Smart Caregiver Corporation devices are designed to be installed by the end user. As such, it is the entire responsibility of the buyer to insure that the system is properly installed and tested. Further, the system is not designed to replace good caregiving practices including, but not limited to:

- A.) Direct patient supervision
- B.) Adequate training for staff personnel for fall prevention and elopement
- C.) Testing of the system before each use

**WARNING:** The manufacturer does not claim that this device will stop elopement and/or stop falls. This device is designed to augment caregivers' comprehensive resident mobility management program. Failure to comply with the warning may result in injury or death. This device is not suitable for all individuals. Other devices may be required. This device is not a substitute for visual monitoring by a caregiver.

Where permissible, it is the seller's intent to limit any liability for special, consequential or incidental economic damages to refund of the purchase price or replacement of the goods. Seller disclaims any liability for compensatory or other damages arising out of the use of the goods.

Limited Warranty: Seller warrants that the goods sold will be free from defects of workmanship and manufacturing, for a warranty period from the date of sale. Other than this limited warranty, seller makes no express or implied warranties. Except for this limited warranty. No express or implied warranties are given and no affirmation of seller, by words or action will constitute a warranty. The goods being purchased are being sold on a "with all faults" basis. The entire risk as to the quality and performance of the goods is with the buyer. Should the goods prove defective following their purchase, the buyer, and not the manufacturer, distributor or retailer, assumes the entire cost of all necessary installation, servicing or repairs.



SMART CAREGIVER CORPORATION

1229 North McDowell Blvd., Petaluma, CA. 94954 | Tel: 800-650-3637

csr@smartcaregiver.com | www.smartcaregiver.com

## See other side for Quick Start Instructions

### TL-2700 Motion Sensor

The TL-2700 Motion Sensing Exit Alarm is extremely easy to use and install. With a range of 30 feet (depending on the environment) this compact wireless unit alerts caregiver when a resident vacates a bed, chair or the caregivers designated area. When the Motion Sensing Exit Alarm is triggered an alarm will immediately sound. An extendable mounting bracket is available to help eliminate false alarms. The Motion Sensor comes with a 90 day warranty.

### TL-2700 Contents:

- Motion Sensing Exit Alarm
- Swivel Bracket
- Optional Accessories:**
- Mounting Bracket Clamp
- Extendable Mounting Bracket

**IMPORTANT OPERATIONAL WARNING:** The alarm will sound until sensor is turned off or reset. Once the alert sounds, it is important to check on the resident IMMEDIATELY.

Need Set-up Help? (800) 650-3637

## 1 How to Activate

- Remove sensor from bracket by gently lifting the bracket over the square pegs. See diagram.
- Insert 9V battery (not included) into battery compartment. (See diagram)
- Close the battery cover and put the bracket back on and wait 10 seconds before use.

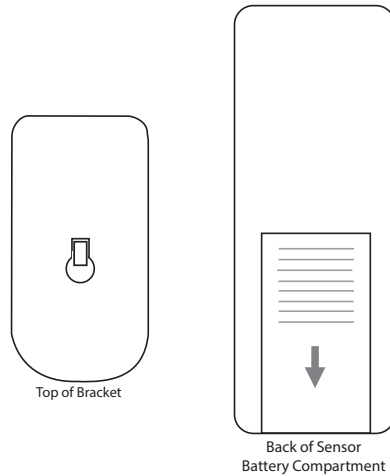

## 2 Adjust Settings

- The chime mode sounds like a doorbell.
- The second setting is OFF mode.
- Please note that the monitor will be shipped with the alarm volume set at 90 decibels per foot (90 decibels is the legally accepted occupational noise allowance).
- Slide switch to off to reset the alarm.

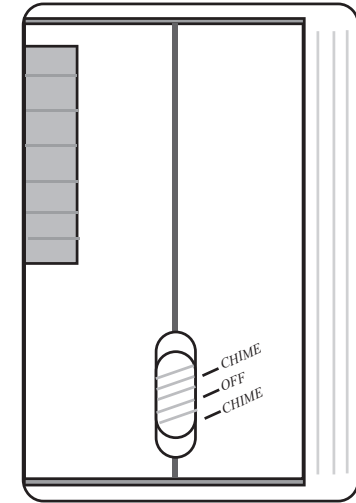

## 3 Sensor Placement

- Mount exit alarm in the desired monitoring area such as residents bedside, chair side or doorway. Make sure the resident cannot tamper with the monitor.
- When installed correctly the unit has a detection coverage of approximately 30 feet (depending on the environment).
- Test all settings before using.

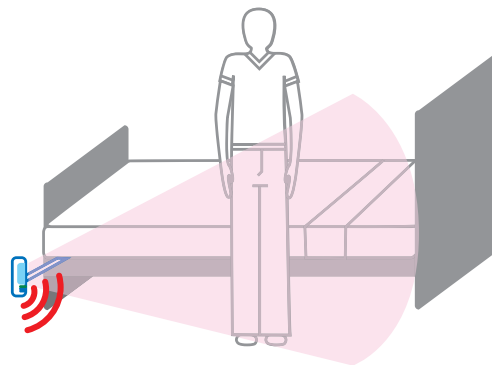

## 4 Exit Alarm Maintenance

- Do not disassemble the main unit.
- Do not install unit in direct sunlight or rain. Avoid places where a drastic change of temperature may occur.
- Do not install unit near heat sources such as stove tops, fans, radiators or illuminators.
- Do not stab or poke lens or speaker.
- Remove battery when not in use for more than a week.

